



2019 EAS CONFERENCE

JULY 15-19, 2019

GREENVILLE CONVENTION CENTER • GREENVILLE, SOUTH CAROLINA

Healthy Bees™ All-Natural Patties & Powders

THE BALANCED NUTRITION YOUR BEES NEED TO STAY HEALTHY

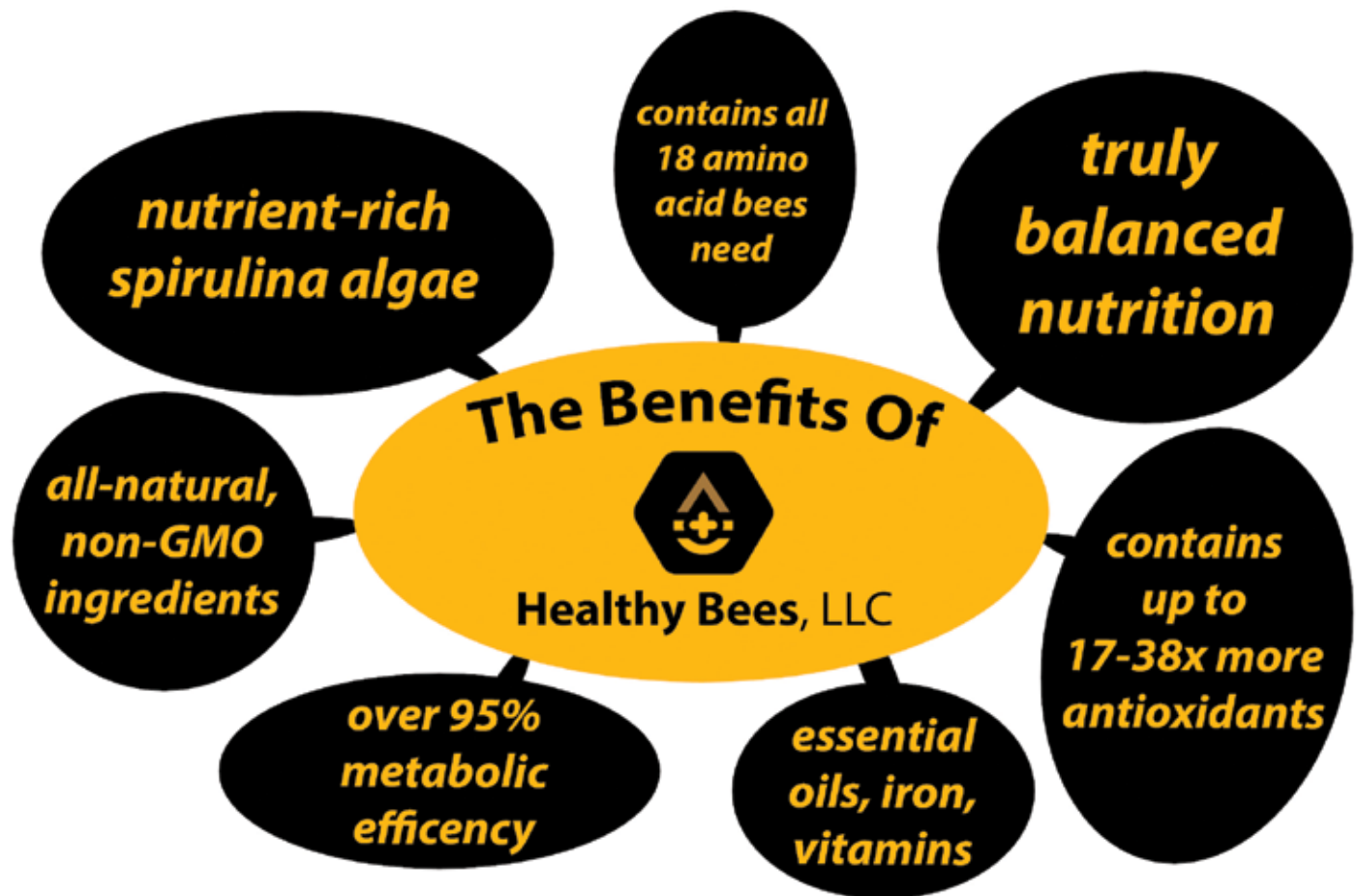

THE PROBLEM

20 years ago, honey bees had access to better forage. Today, human expansion and the overuse of herbicides have left little remaining for our honey bees.

THE SOLUTION

Regular use of Healthy Bees™ provides bees with vitamins, minerals, and micronutrients. Healthy Bees™ also contains the exact amino acid profile bees need (De Groot, 1964) to synthesize protein. On top of that, the antioxidants present in Healthy Bees™ can limit oxidative stress caused by pesticide exposure.



LACK OF FORAGE:
SOLVED



SPIRULINA
A SUPERFOOD



PESTICIDE DAMAGE:
SOLVED



Healthy Bees, LLC

Please come check out our gold-sponsored booth!

For discounts on commercial orders, call: (786) 524-9200

(To learn more, visit us at: www.healthybeesllc.com)



Healthy Bees, LLC

2019

CONFERENCE PROGRAM



TABLE OF CONTENTS

President's Message	2
Welcome From the Chair.....	3
Schedule Overview.....	5
Registration Schedule	
Master Beekeeper Schedule	
Society Meeting Schedule	
Annual Honey Show Schedule	
Sponsors of the 2019 EAS Conference.....	6
Master Beekeepers Happenings in Virginia	7
Keynote Speakers.....	8
EAS Award Winners.....	14
Roger A. Morse Outstanding Teaching/Extension Service/Regulatory Award	
James I. Hambleton Memorial Award	
Charles & Evelyn Divelbiss Education Award	
Research Awards	
Student Award	
Conference Welcome	18
Registration, Meals and More.....	21
Vendors.....	22
Greenville Convention Center Map.....	24
Short Course Schedules	26
Conference Program Schedules.....	28
American Honey Princess.....	31
Speaker Schedule.....	32
Special Events.....	38
Conference Features	43
Other Local Attractions and Events	47
Come See Maine for EAS 2020	48
Notes	50

AT A GLANCE

Sunday	Registration and Information Desk 4:00-7:00 pm EAS Board Meeting 7:30 pm
Monday	Registration and Information Desk 7:30 am-4:00 pm Short Course 8:30 am-to 5:00 pm Greenville Walking Tour 6:10-7:30 pm
Tuesday	Registration and Information Desk 7:30 am- 4:00 pm Short Course 8:30 am- 5:00 pm Vendor Exhibit 10:30 am-5:00 pm Honey Exchange Drop Off 8:00 am-5:00 pm, Ballroom (rear) Honey Show Entry Drop Off 3:00-6:00 pm Iron Hill Brewery Tour 6:00-9:00 pm
Wednesday	Registration and Information Desk 7:30 am- 4:00 pm Honey Show Entry Drop Off 8:00-11:10 am Honey Exchange Drop Off 8:00 am-3:00 pm, Ballroom (rear) Conference 8:15 am-3:45 pm Vendor Exhibit 8:15 am-3:00 pm Southern Buffet, Bee Olympics and Band 5:00-9:00 pm
Thursday	Registration and Information Desk 7:30 am- 4:00 pm Honey Exchange Drop Off 8:00 am-5:00 pm, Ballroom (rear) Conference 8:15 am-5:15 pm Vendor Exhibit 8:15 am-5:15 pm Silent Auction 2:30-6:00 pm Social with Cash Bar 5:00-9:00 pm Dinner 6:30-8:00 pm Live Auction 8:00-9:30 pm
Friday	Registration and Information Desk 7:30 am-12:00 pm Conference 8:15 am-5:15 pm Vendor Exhibit 8:15 am-4:15 pm EAS Membership Meeting 11:15 am-12:00 pm Honey Exchange Pickup 8:00 am - 2:00 pm, Ballroom (rear) Honey Show Pickups 2:30 - 5:00 pm Social with Cash Bar 5:00 pm-9:00 pm EAS Annual Banquet and Awards 6:30-9:00 pm

PRESIDENT'S MESSAGE

Welcome to the EAS 2019 Conference in the beautiful and prosperous City of Greenville, South Carolina. The beekeepers of South Carolina, in conjunction with the Eastern Apicultural Society are pleased to host the EAS 2019 at the Greenville Convention Center on July 15 – 19, 2019. This is the first EAS Conference to be held in this fair state and everyone is appreciative and excited to have the presence of EAS members and the large number of speakers to share their knowledge and experience with those persons that are in attendance.

Beekeepers are a very unique group and are grounded in the beauty of nature that surrounds us. We have much to be grateful for the *Apis mellifera* L. Many scientists and practitioners that have gone before us have researched many aspects of the honeybee. The research and practical application continue and many new challenges and opportunities of recent have been identified. We all strive to learn more of this magnificent insect and enjoy each day of our involvement.

We encourage you to visit the vendors who mean so much to the success of this conference. Tours of Greenville and a commercial beekeeping operation have been arranged for your enjoyment. We hope you can manage time to enjoy these activities. Many hours of preparation have been gladly provided by many to produce the EAS 2019. Welcome to Greenville, South Carolina and we wish you a very enjoyable and educational experience.



Ralph C. (Buddy) May Jr.

President EAS

EAS Master Beekeeper

South Carolina Master Craftsman



WELCOME FROM THE CHAIR

Welcome to South Carolina and to Greenville! We are so pleased that South Carolina is hosting EAS for the first time ever! Please make some time to explore what this great city has to offer.

We are thrilled to have this opportunity to share and learn together.

Our program this year is exquisitely planned, featuring many beekeeping experts and scientists, and very prominently featuring many of our own Master Beekeepers. EAS's mission focus of certifying this team of experts is core to everything we do, and we know that you will enjoy their presentations greatly.

As you can see from the program schedule (pg 28) we have another amazingly robust program this year, with multiple levels in the short course including queen rearing and lots of tracks designed to increase your practical apiary management skills. The main conference is packed full with a wide variety of topics. From practical pest management strategies to beekeeping travel stories, there is something for everyone at every time slot.

We are looking forward to an exciting week of education, skill building and knowledge sharing. We hope you will find lots of time to meet people, make new friends, and catch up with colleagues. I strongly encourage you to make that extra effort to connect with other conference attendees – this is the time to build your network of beekeeping friends and mentors.

Our evening events provide an opportunity to meet fellow beekeepers at all levels, make lasting connections, and share some laughs and good times over a great South Carolina style meal. Our evening events are all graciously hosted at the Hilton Hotel, and we expect an especially lively auction Thursday night that you won't want to miss. Friday night's banquet and certification of Master Beekeepers is another must attend event to cap off the week. We have another record group of Master Beekeeper Candidates this year and as always we are honored to be a part of these folks' journey to become Beekeeping Ambassadors.

Finally, we are so honored by the wonderful volunteers who have made this conference happen. EAS is a volunteer run organization from top to bottom, and many people have been working hard to make this week happen for two and three years, or more! Buddy May and his team have been an amazing group to work with, the Executive Committee and Board of Directors are as always critical participants, and of course the Master Beekeepers have been working hard behind the scenes to make Eastern Apicultural Society one of the greatest beekeeping organizations anywhere. If you see someone with a "volunteer" t-shirt or flag on their lanyard, please take a moment to thank them! We are sincerely appreciative of all who participate. If you are new to EAS and want to get involved, please get in touch with any member of the Board and we will be happy to help you find a role that fits your qualifications and interest.

My very best to all of you and your bees, and most of all, Enjoy EAS 2019!

Erin MacGregor - Forbes

Erin MacGregor-Forbes, Chairman
Eastern Apicultural Society



ApiLifeVar



THE BEST NATURAL ALTERNATIVE AGAINST VARROA

**RESULTS IN BEST OVERWINTER SURVIVAL
WHEN USING A NATURAL PRODUCT
FOR 3 YEARS**

NATIONAL MANAGEMENT SURVEY
BEE INFORMED PARTNERSHIP 2015



REGISTERED
IN 35 COUNTRIES
THYMOL-PRODUCT
MARKET LEADER IN EUROPE

WINTER LOSSES ACCORDING TO THE TREATMENT

Bee Informed Partnership survey

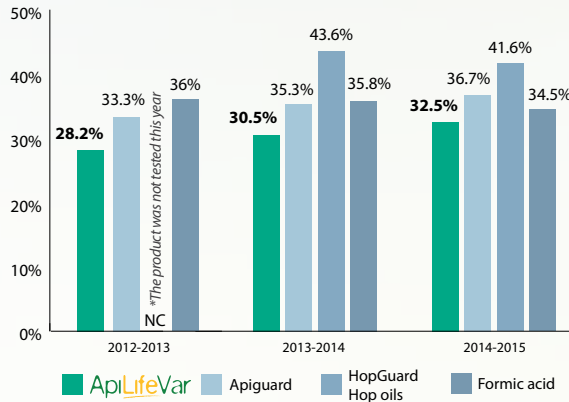

In addition, beekeepers who reported treating with **Apilife Var** lost **31.9% fewer colonies** than those who reported **NOT** treating with any varroa mite control product.

On the same survey, Apiguard loss reduction was only 23.1%.

Bee Informed Partnership 2015 survey



MORE THAN THYMOL:
Synergy of 4 essential oils to ensure
a better control release of thymol in-hive



THYMOL



EUCALYPTUS OIL



L-MENTHOL



CAMPHOR

Active ingredients

NATURAL
INGREDIENTS

UP TO 94%
EFFICACY*

NO VARROA
RESISTANCE
DEMONSTRATED

Available from:

MANN LAKE
WE KNOW BEES
An Employee Owned Company



ALV-02-US-N02-12/17

*Field trial with different thymol-based products for the control of varroosis - Baggio et al. - Italy - 2004 (94,7%)

Check out our other solutions to support honey bee health in the US:



SCHEDULE OVERVIEW Sunday, July 14 to Friday, July 19, 2019

GCC - Greenville Convention Center

Registration and Information Desk - GCC	
Sunday	4:00 pm - 7:00 pm
Monday	7:30 am - 4:00 pm
Tuesday	7:30 am - 4:00 pm
Wednesday	7:30 am - 4:00 pm
Thursday	7:30 am - 4:00 pm
Friday	7:30 am - Noon



The mother of the EAS conference! **Thursday, August 3 2017**

THESE ARE THREE ROOMS OF VENDORS. Be sure to visit them all!

Looking for a place to eat out? Deer Park Tavern Bar and Grill 188 W. Main Street Newark Thursdays All the Chicken wings you eat \$19.99 after 5pm.
Also just 1.8 mile North on 1966 New London Road are Nick and Sue's Place 302-292-3726, 413 New London Rd. (1966) Newark DE 19711 10am-9:30pm
New Number One Chinese Restaurant 302-368-0811
417 New London Rd. Newark DE 19711 10:30am-10:30pm Both have take out!

MEAL CAVE: **IMPORTANT****** All meal cards must be returned to the registration desk (the swipe cards for the cafeteria). **Unreturned meal cards will cost you \$35.00.** Please do not forget to return them!

Someone asked me the other day if I lived in Delaware: all my

Advice from Dr. Nasonov

Dear Dr. Nasonov,
I'm told by my mates that I'm a handsome drone. Do you think I'd have a chance with Queen Amelia from the hive down the road? Should I go for it?
Signed, Stud Muffin

Dear Stud Muffin,
No way! She gets around. I forsee an exhilarating but abbreviated relationship. Your happiness will be short lived.
-Dr. N.

Dear Dr. Nasonov,
Admittedly I've been frequenting flowers where I've met bees from another hive. Undoubtedly I've contracted

Look for the daily Waggle at the registration desk for updates and daily happenings!

Master Beekeeper Schedule			
Meet and Greet Candidates	Monday	12:00 pm - 1:30 pm	Room 202C, GCC
Pre-Exam Q&A	Monday	1:30 pm - 3:00 pm	Room 202C, GCC
Volunteer Dinner	Monday	5:30 pm - 7:30 pm	TBD
Candidate Written Exam Group Study	Monday	7:00 pm - 9:00 pm	Room 101A, GCC
Written Exam	Tuesday	8:30 am - 12:30 pm	Room 201, GCC
Master Beekeeper Administration	Tuesday	Open All Day	Room 201, GCC
Oral Exam	Tuesday	8:00 am - 4:40 pm	Rooms 201 after written exam Rooms 101A, B, 100A after lunch
Lab Exam	Wednesday	8:30 am - 12:30 pm	Rooms 201
Field Exam	Wednesday	10:00 am - 4:00 pm	Apiary
Master Beekeeper Annual Meeting	Friday	7:30 am - 8:30 am	Room 101A
Exam Results Review (Candidates receive scores and get questions answered.)	Friday	3:00 - 4:00 pm	Room 101A

Society Meeting Schedule			
EAS Board of Directors' Meeting	Sunday	7:30 pm	GCC
Life Members Lunch	Thursday	12:00 pm - 1:30 pm	Room 102C
Welcome to EAS Annual Meeting - Buddy May	Friday	11:00 am - 11:15 am	Ballroom, GCC
EAS Annual Meeting Everyone is encouraged to attend.	Friday	11:15 am	Ballroom, GCC

2018 Annual Honey Show Schedule			
Drop Off Show Entries	Room 202B	Tuesday	3:00 pm - 6:00 pm
Drop Off Show Entries	Room 202B	Wednesday	8:00 am - 11:00 am
Show Open	Room 202B	Thursday	8:00 am - 6:00 pm
		Friday	8:00 am - 3:00 pm
			Note that some entries will be auctioned off Thursday evening and will not be on display Friday
Silver Awards Presentation	Ballroom BC	Thursday	During Evening Dinner, Hilton Hotel
Post-Show Pickup of Entries	Room 201-202	Friday	2:30 pm - 5:00 pm

SPONSORS AND DONORS OF THE 2019 EAS CONFERENCE

Not only do we want to thank those people, businesses and organizations that support the 2019 program but also appreciate the value in products and information that they bring to the experience. Their participation enriches our knowledge of what services and products are out there.

Please make sure you let them know how much you appreciate their part by supporting them and letting them know you are glad they are part of this.

Donors

COLONY LEVEL

Moorestown Honey Works

Linda Mizer

Dorinda Priebe

QUEEN LEVEL

Dewey M. Caron

Andrew Dewey

New Hope Honey Farm

Union County Beekeepers

WORKER LEVEL

Robert Byrd

Douglas Galloway

DRONE LEVEL

Sam Golston

HONEY BEE RESEARCH

Blueberry Hills Travelers Rest

Robert Byrd

Douglas Galloway

Sam and Cindy Golston

New Hope Honery Farm

Wild Mountain Honey

SPEAKER & EDUCATION FUND

Douglas Galloway

New Hope Honey Farm

Sam and Cindy Golston

Sponsors

GOLD LEVEL

Healthy Bees, LLC.

SILVER LEVEL

Kelly Bees

BRONZE LEVEL

Dadant

Flow Hive

Mann Lake Ltd.

Pierco

Designated Sponsorships

CONFERENCE BAGS

South Carolina Farm Bureau

LANYARDS

Betterbee

HONEY SHOW

American Bee Journal

Bee Culture Magazine

Buffy Bee Company

Busy Bee Company

Dadant

Maine State Beekeepers Association

Mann Lake Ltd.

Maryland State Beekeepers Inc.

South Carolina Beekeepers Association

W. Fisher Bee Farm

CONFERENCE BREAK

Gamber Container

Spartanburg Beekeepers

SHORT COURSE BREAKS

Charleston Community Bee Gardens and Charleston Area Beekeepers

Mountain Honey

New Jersey Beekeepers Association

MASTER BEEKEEPER'S WELCOME TO SOUTH CAROLINA

by Landi Simone, EAS Advisor

Welcome to the EAS Conference from the Master Beekeepers!

For those of you who are attending the conference for the first time, please don't be alarmed if you see some very anxious-looking people with their heads buried in books or frantically rushing to and fro – sometimes with smoker, veil and hive tool dangling from various appendages. It's just our current crop of Master Beekeeper candidates either studying for or going to one of the four examinations they must pass in order to become certified as EAS Master Beekeepers. Certification of new Master Beekeepers is one of EAS's prime objectives. The program was started by Roger Morse at Cornell back in the 1970's and is one of the oldest and most respected in the country. If you're interested in finding out more about the process, the EAS website has lots of excellent information. Please read all about us! And maybe, in another year or so, it will be you scurrying around!

And if you happen to be one of those doing the scurrying, remember, every one of the beekeepers helping with the testing has been in your shoes. We all understand how stressful it is! Try to relax, eat, get a good night's sleep (all more or less impossible!) Bear in mind that it's not the end of the world if you don't pass. The sun will still rise on Thursday morning. You'll still be at EAS with many friends, listening to great speakers and participating in fun activities. You'll be able to retake any sections you didn't pass in future years, and you'll have a far better idea of what to expect. And best of all, you'll be a better beekeeper just because you made the commitment to take and study for this very challenging and rigorous test of your knowledge.

We're all rooting for you! Now go break a hive tool!

Landi Simone
EAS Certified Master Beekeeper
Chair, Certification Committee



KEYNOTE SPEAKERS

Wednesday Keynote Speakers



DEWEY CARON AND MATT MULLICA

The initial Keynote address will be a tag team discussing the Honey Bee Health Coalition. EAS supports the HBHC effort of beekeepers, growers, researchers, government agencies, agribusinesses, conservation groups, manufacturers, and consumer brands all dedicated to improve the health of honey bees in general and specifically around production agriculture. HBHC task forces seek collaborative action to improve honey bee health by addressing multiple factors influencing bee health, including hive pests and disease, forage and nutrition, and exposure to crop pesticides. The Coalition is facilitated by the Keystone Policy Center. Tammy Horn Potter represents EAS and is a member of the HBHC Steering committee.

Dewey Caron retired in 2009 after 29 years at University of Delaware initially as Department Chairman and 11 years at University of Maryland, College Park. Originally from Vermont, he currently resides in Portland OR (to be closer to his 5 grandchildren). He is Emeritus Professor of Entomology and Wildlife Ecology, University of Delaware and currently Affiliate Professor of Horticulture of Oregon State University.



Dewey is no stranger to EAS, even following retirement and movement to Oregon. He is a 52 year veteran of EAS conference attendance (1977 MD), a Past President (1986), State Director (MD and DE), was Chairman of the Board (1991-99), helped initiate the EAS Short Course (1980) and Master Beekeeper Programs (1981) and was Chair of the EAS Research Foundation during time the initial awards were given. In addition to being a frequent conference/short course speaker and honey judge he has served several times as Program Chair, including this year in cooperation with David MacFawn. He has been the recipient of both Divelbiss and Morse Awards.

Dewey represents WAS (Western Apiculture Society) on the HBHC board. Most recently he has been principle author of the Hive Management Task Force publications of *Tools for Varroa Management and Best Management Practices* and as contributor for the Veterinary Feed Directive (VFD) flyer. He will outline the Best Management Practices and Tools publications to begin the 2019 EAS conference.

Matt Mullica is a Policy Facilitator with the Keystone Policy Center, providing mediation, facilitation, and project management services within Keystone's environment, energy, and agriculture practice areas. Matthew works with diverse public, private, and NGO stakeholder groups and designs and facilitates stakeholder dialogues, public engagement processes, coalitions, and strategic planning processes. Matt is a Facilitator of the Honey Bee Health Coalition and Monarch Collaborative. He is also involved in other Keystone projects including water, sustainable agriculture and ranching, oil and gas development, as well as several projects involving National Environmental Policy Act (NEPA) processes.

Matthew lives in the Mountains in the front range of Colorado. He graduated with a Master's of Science International and Intercultural emphasis in Conflict Resolution, from Portland State University, Portland, OR and holds two Bachelor of Science degrees in marketing and management from the University of Montana. He enjoys living the outdoor recreation lifestyle. He has had a recent family edition of a girl to go with her two brothers. He will highlight HBHC programs directed toward Bee Health and can be found at the HBHC informational booth during the remainder of the conference.



JENNIFER BERRY

Jennifer Berry, our 2019 Roger A. Morse Outstanding Teaching/Extension Service/Regulatory Awardee, is also a Keynote Speaker on Wednesday. For the past 20 years Jen has been the Lab Manager for the University of Georgia Honey Bee Program. She conducts considerable Outreach/Extension programs and also has done teaching, especially on how to raise queens on her farm, using her own bees. She sells queens that she raises each year.

Jen Berry is no stranger to the EAS annual Short Course or Conference. This year she will be offering a day-long queen rearing course on Tuesday in the Short Course. She was featured keynote speaker at University of Delaware in 2017. She frequently attends the Heartland Apicultural Society (HAS) and has been a speaker at many state bee conferences as far west as Idaho.

Jennifer has been the guiding mentor for virtually all University of Georgia graduate students over the years. She has been the major organizer for the annual Georgia Master Beekeeper program training and testing effort at Young Harris University (in the Georgia Mountains) since its inception. She has taught in the Institute program each of those years. The Georgia Master Beekeeper program is one of the very best, along with our own,

and it is largely due to Jennifer's organizational abilities and her emphasis on maintaining high standards in the instruction and testing efforts.

She has been the "driving force" offering a novel program "WILL WORK FOR FOOD". This is an instructional program directed toward youngsters that teaches about beneficial insects including, of course, pollinators and the needs for conservation of pollinators and other beneficials.

Jennifer has a first rate instructional program helping inmates of the Georgia prison system. She personally attends and has organized a cadre of beekeepers to offer instruction at both Maximum and Medium security prisons. The inmate program, part of the Georgia Master Beekeeping program, has to date certified almost 100 individuals. For some inmates, this represents a skill they can use as they seek to return and adjust to life outside the prison system. Jennifer will share her program with the South Carolina prison beekeeping teaching effort in a Wednesday afternoon workshop.

Many beekeepers are aware of Jennifer's writing about bees. She seeks to extend University research beyond the University system as a frequent bee journal contributor. *Don't miss Jennifer Berry at the 2019 conference in South Carolina! On Tuesday, Jennifer presents a day-long queen rearing course and on Wednesday she is a featured keynote speaker.*

Compiled by Dewey M. Caron

Thursday Keynote Speakers



KIRSTEN TRAYNOR

An avid beekeeper, scientist, and writer, Kirsten Traynor has had the opportunity to travel the globe in pursuit of bee knowledge. Fascinated with the social complexity of a honey bee hive, Kirsten received a prestigious German Chancellor Fellowship from the Humbolt Foundation. She drove over 50,000 miles throughout Western Europe to study the differences between European & American beekeeping.

She earned her PhD in Biology from Arizona State University with Dr. Robert Page. While a graduate student, she spent almost a year in Avignon, France in the lab of Dr. Yves Le Conte as a Fulbright Fellow.

As an USDA NIFA ELI Postdoctoral Fellow at the University of Maryland, she investigated how pesticides impact honey bee health with Dr. Dennis vanEngelsdorp. She's currently a Fellow at the Wissenschaftskolleg in Berlin, Germany. She served as Editor of American Bee Journal from 2015-2017 and edited Bee World, published by the International Bee Research Association.

She is the author of *Two Million Blossoms: Discovering the Medicinal Benefits of Honey* and *Simple, Smart Beekeeping*. She has been an editor for both. Her goal is to "teach numerous beekeeping classes and

frequently speak to beekeepers, garden clubs, schools, and other organizations"

Kirsten manages a small, sustainable apiary (Flickerwood Apiary) producing top quality nucs and locally adapted, Maryland-reared queens. She markets gourmet honey. Using the biology of the bee against the biology of the Varroa mite, she keeps her colonies healthy without synthetic chemicals.

Kirsten gives her keynote address Thursday morning Thursday *2 Million Blossoms - Protecting Our Pollinators* and two workshops - Thursday 1:30 PM to 2:30 PM *Good Science In Your Backyard: How To Test New Products For Varroa Control* and Friday 4:00 PM to 5:00 PM *Honey As Medicine: What Does The Science Say?*

Compiled by Dewey M. Caron



JAY EVANS

Jay Evans is Research Leader at the United States Department of Agriculture (USDA) Bee Research Laboratory in Beltsville, MD, where he has worked for 20 years, initially as a Research Entomologist. The Beltsville Bee Laboratory, with Jay as their Research Leader since Fall of 2014, researches the development of management strategies to help honey bees thrive in the face of disease, chemical stress, and inadequate forage. Lab members are developing and testing new nutritional and anti-disease products, and are especially interested in how bees respond to multiple stress factors and the efforts beekeepers might use to help them through these challenges. The Bee Lab provides the service of identification of bee diseases for beekeepers.

Jay, originally from Seattle, Washington, received his BA in Biology from Princeton University in 1988 where he was introduced to ants (there was nobody studying bees at Princeton at that time). His PhD is from the University of Utah (1995). He did much of his field studies at Rocky Mountain Biological Laboratory, a field biology station in Colorado. He continued his work on a species of ants noteworthy in that they raise multiple queens. He spent a short year at the University of Georgia working on an imported fire ant project.

Jay was introduced to honey bees when he joined a research team at University of Arizona that was examining the ecology of social insects and their rearing of multiple queens. From Arizona, Dr. Evans was recruited to join ARS as a Research Entomologist in 1998. His research has focused on threats to honey bee health, including initially American Foulbrood and then to mites and on the ways bees and beekeepers can reduce their negative impacts. Dr. Evans was an early proponent of the Honey Bee Genome Project and helped recruit and lead scientists interested in applied genomics for bees. He has published over 130 research papers from his work.

Jay's current research uses genetic techniques and via controlled challenge experiments he seeks to find new ways to reduce the impacts of parasites and pathogens. Current projects involve honey bee immunity, interactions among stress factors, and the development of novel, safe, controls for mites and viruses. He has received the James Hambleton Bee Research Award from the Eastern Apicultural Society (2011), the BA Early Career Scientist Award (2002), and is on the Council of Fellows for the International Bee Research Association.

His keynote address will be Thursday morning *Genes, Germs and Stress: Helping Bees To Help Themselves*. He will do two workshops - Wednesday 1:30 PM to 2:30 PM *Future Of Microbials* and Thursday 3:00 PM to 4:00 PM *Novel Control Strategies for Bee Viruses*.

Compiled by Dewey M. Caron

Friday Keynote Speakers



MEGHAN MILBRATH

Dr. Meghan Milbrath is currently an academic specialist at MSU, where she does honey bee and pollinator research and extension. She also is the coordinator of the Michigan Pollinator Initiative. She is passionate about keeping and promoting healthy bees.

Megan initially became interested in bees helping her dad in Northern Wisconsin in the bee yard, peering over his shoulder as he worked in the family hives. She began working bees in 1994, and used bee income to help pay for her college costs at St. Olaf College in Northfield, MN. where she studied biology. Meghan continued in graduate studies receiving degrees in public health from Tulane University and the University of Michigan, where she focused on modeling environmental health sciences and disease transmission risk. She continued with beehives as a hobby which she says were “an escape from the stress of my doctoral research”.

She says of her studies “The parallels between what was happening to bees and some of the things affecting humans were obvious. As I studied emerging diseases in humans for my dissertation, I read about the new pests and pathogens affecting honeybees. I modeled the effect of environmental exposure to persistent pollutants on

humans and learned about the complex mixtures of pesticides and other chemicals that bees are exposed to in the nectar and pollen of the plants”. Prior to her current position Meghan worked as a postdoctoral research associate with Zachery Huang studying nosema disease at Michigan State University. She currently owns and manages The Sand Hill Apiary, a small livestock (hogs and chickens) and honey production queen rearing operation in Munith, Michigan, managing 200 colonies. Meghan is active in multiple beekeeping organizations, writes for multiple beekeeping journals, and speaks about bees all over the country. She currently runs the Northern Bee Network, a directory and resource site dedicated to supporting queen producers.

Her keynote will be Friday *The Greatest Generation: Protecting Our Winter Bees*. She also will give two workshop. The first on Wednesday *Foulbrood Disease In Honey Bee Colonies* and the second on Friday afternoon - *Splits For Swarm Control*.

Compiled by Dewey M. Caron



Betterbee™

Beekeepers Serving Beekeepers

800-632-3379

betterbee.com



Stop by our booth and check out some of our Lyson products!

HIVES



EXTRACTORS



Proud US distributor of

LYSON

Lyson is an award-winning Polish company that manufactures and distributes beekeeping equipment and supplies. We work closely with product developers at Lyson to introduce new products desired by our American market!

Contact Betterbee or your local Lyson dealer to order!

NUCS



CANDLE MOLDS

FS58

FS59

FS36

FS02

F031

FS27

CREAMERS

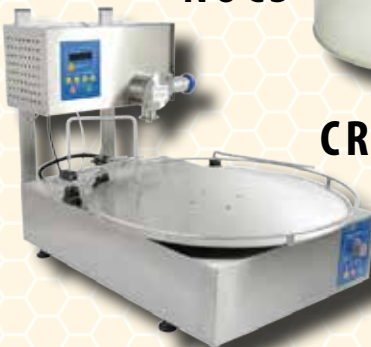

BOTTLERS



Proudly carrying:



2019 EAS AWARD WINNERS

THE ROGER A. MORSE OUTSTANDING TEACHING/ EXTENSION SERVICE/REGULATORY AWARD SUPPORTED BY ANITA WEISS FOUNDATION

by Peggy McLaughlin

*The **Roger A. Morse Outstanding Teaching/Extension Service/Regulatory Award Supported by Anita Weiss Foundation** is given annually to recognize an individual in teaching/extension and/or regulatory activity in the field of apiculture.*

The 2019 recipient of the Roger A. Morse Award stands out in the world of apiculture not only for the depth and breadth of her teaching and outreach, but for her great generosity of spirit. The many letters of nomination received on behalf of Jennifer Berry were generous too, heaping well-deserved praise on someone whose efforts have been, according to one supporter, “deeply impactful...on so many individuals.”



Jennifer Berry is a Research Professional IV and Lab Manager for the Honey Bee Program, Department of Entomology, at the University of Georgia. For over twenty years, she has taught, mentored, organized beekeeper training programs, and presented to the beekeeping community around the world. Jennifer has been the major organizer for the annual Georgia Master Beekeeper Program training and testing at Young Harris University and a mentor for virtually all UGA students over the years. “She is the glue and resolve that has helped UGA develop a renowned Beekeeping Program,” wrote one supporter, and from another, “She is a model ambassador for bees and beekeeping.”

Jennifer has been instrumental in helping educate inmates of the Georgia prison system in the art of beekeeping, both in maximum and medium security prisons. To date nearly 100 individuals have been certified. She also developed the “Will Work for Food” program to teach young people about beneficial insects, including pollinators, and the need for conservation.

Jennifer lent her considerable expertise and talents to the team that coordinated the development and publication of *Protecting Georgia's Pollinators: A State Plan for promoting a large, healthy and diverse pollinator workforce* and took the lead in publishing the final document. Her design skills were further utilized to create the “Georgia Bee Aware” flag.

Her teaching extends well beyond the state of Georgia and many beekeepers will recognize Jennifer from her regular articles in beekeeping journals. She has been extremely dedicated to EAS, where she has been a frequent speaker and participant at the annual conference. Her thoroughly prepared and enthusiastic presentations, workshops, and events, including a very popular queen rearing track, have been in high demand since 2003. Her fascination with bee biology is infectious and to those who know her she is “...a master at keeping her outreach engaging, relevant, and in alignment with the latest scientific findings.”

Jennifer Berry has touched many lives as a dedicated Extension Apiculturist. Her unique style of educating beekeepers and the general public alike about bees and beekeeping has influenced many. As one supporter stated so well, “What makes Jennifer exceptional is not just the sheer number of outreach and educational projects that she has pursued throughout her career, but the passion with which she does it and the exponential effects from these efforts on the beekeeping industry and on society at large.”

Don't miss Jennifer Berry at the 2019 conference in South Carolina! On Tuesday, Jennifer presents a day-long queen rearing course and on Wednesday she is a featured keynote speaker.

THE JAMES I. HAMBLETON MEMORIAL AWARD

by Peggy McLaughlin

The **James I. Hambleton Memorial Award** was established by the Eastern Apicultural Society of North America to recognize research excellence in apiculture.

EAS is proud to present the 2019 James I. Hambleton Memorial Award to Dr. Reed Johnson, Associate Professor, Department of Entomology, Ohio State University. Dr. Johnson is a leader on the toxic effects of pesticides on honey bees and is considered by many to be the most prominent toxicologist in apicultural research today.



Dr. Johnson completed his PhD at the University of Illinois, Urbana-Champaign in 2008 under noted entomologist, Dr. May Berenbaum. His project merged new technologies from genomics with traditional toxicology on non-target insects such as honey bees. Regulatory agencies and beekeepers alike became aware of the sublethal effects of pesticides on honey bees because of his “trailblazing” research.

During a two-year post-doctoral position at the University of Nebraska with Dr. Marion Ellis, Dr. Johnson studied the synergistic effects of synthetic acaricides. This work, as noted by one of his nominating supporters, “...is still hailed today as some of the best examples of how pesticides can be fairly benign individually but can have a 1,000-fold increase in toxicity when used together.”

In his current position at the Experiment Station in Wooster, Ohio, Dr. Johnson conducts research, teaches, and provides beekeeper education through extension services. His lab focus seeks to understand how to protect pollinators from the pesticides and other toxins they encounter. He has been a leader in determining the impact of corn seed treatment insecticides on honey bee colonies and has investigated the potential harmful role of inert ingredients on honey bees when exposed to pesticides. Additional areas of research include the effects of urbanization and management techniques on beekeeping, pollen barcoding for high-throughput analyses of foraging sources, and pesticide exposure in agroecosystems.

Dr. Johnson’s extensive and diverse published papers are “simply an outstanding contribution to honey bee science,” and to the hobbyist beekeeper, his extension work, information notes, presentations to local, state, and regional beekeeper groups, and citizen science project on brood frames, consistently enlighten and inform.

Dr. Johnson’s research has advanced our scientific understanding about honey bees, in particular, the potential threats they endure from pesticides. We look forward to his future contributions in the fields of toxicology and apiculture.

Be sure to hear Dr. Johnson speak on Thursday morning, “Solving Problems at the Intersection between Bee Foraging and Pesticide Application” and Thursday afternoon, “An Overview of Honey Bee Pesticide Testing and Regulatory Toxicology”

CHARLES AND EVELYN DIVELBISS EDUCATION AWARD

At each annual conference, the Eastern Apicultural Society presents the Charles and Evelyn Divelbiss Education Award. This award is presented to that person or couple who has—over a period of years—reached out to the non-beekeeping public to explain the value of honey bees in our lives.

The nominee does not need to be from your own state or province. You may wish to announce this request for nominations at beekeeping meetings and in their newsletters. Feel free to contact officers of state and local organizations to request their suggestions for possible candidates and letters of support.

The nomination process is easy. Write a letter outlining how the candidate has reached the public over the years. Groups, such as 4-H clubs, scouting organizations, school groups, community organizations, Lions Clubs, and garden clubs, as well as media interviews and exhibits at county and state fairs, qualify as non-beekeeping public.

Although the main criteria are edification of the public, the letter may also include activities that teach Short Courses and other instructional work toward educating beekeepers and prospective beekeepers. The nominee does not need to be a member of EAS (but the Society would be delighted if the recipient would join).

This year no nomination was brought forward, but we would encourage each state/province to consider their membership and submit a nomination for next year as we recognize the previous years' awardees, below.

PREVIOUS DIVELBISS AWARD RECIPIENTS

1988	Al Delicata ME	1999	Dewey Caron DE	2010	Ann Harman VA
1989	no award	2000	Robert Cole NC	2011	Billy Davis VA
1990	Charles Mraz VT	2001	Francis Bowen CT	2012	Bill Mares VT
1991	Bob Haas NC	2002	Richard Johnson NY	2013	Becky & Ted Jones CT
1992	Paul Montaux Canada	2003	Tony Jadczk ME	2014	Virginia Stephens Webb GA
1993	Stanford Brown ME	2004	Dan Conlon MA	2015	Sam Hall MY
1994	Cliff Sunflower PA	2005	Sherry Ferrell & Dave Heilman OH	2016	Tim Schuler NJ
1995	George & Doris Payne DE	2006	Ed Holcombe TN	2017	Ray Walker DE
1996	Robert Hughes NJ	2007	Robert Mitchell DE	2017	Alex Zomchek OH
1997	Jerry Caldwell DE	2008	Bill Troup MD	2018	Michael Palmer VT
1998	George Imire MD	2009	Richard Crawford NY		

STUDENT AWARD

by Peggy McLaughlin

The **EAS Student Apiculture Award** was established to recognize students studying apiculture at the undergraduate or graduate level in a recognized college or university in the United States or Canada.

This year's Student Apiculture Award recipient is Lauren Rusert from North Carolina State University. Lauren joined Dr. David Tarpy's lab in 2017. Her graduate studies are focused on honey bee queens, their biology, and their application to apiculture.



Lauren's interest in apiculture began during an undergraduate class at Penn State University taught by Maryann Frazier, where she worked as the lab's field technician for 3 years. During her last year at Penn State, she worked with nutritional diets in Brazil in David De Jong's lab. After graduation, she moved to Hawaii where she took a job as an apiary technician and helped develop the Hawaiian Department of Agriculture's new Apiary Inspection Program. Her last two years there, she oversaw the entire program and was the Hawaii Apiary Section Chief. In Hawaii, she worked closely with large-scale commercial queen producers and conducted research. The Hawaiian Islands provided a unique opportunity for Lauren to study queens from both varroa-free and varroa-infested islands. According to Dr. Tarpy, Lauren's work on mating biology and population genetics is "poised to make a significant impact" in the field of apiculture.

In addition to her current MS work at NCSU, Lauren conducted research this past summer on queen acceptance into new colonies. She has been a dedicated instructor and practitioner of extension and outreach, and has co-authored many articles and extension notes on a variety of topics. She has been described by co-advisor Dr. Jeff Pettis as "an excellent role model" and "the type of student we want to promote in Apiculture, Entomology and science."

WE'VE GOT YOU COVERED

WITH OUR FULL LINE OF HIVE KITS AND EXPERIENCED SALES TEAM, WE ARE HERE TO HELP YOU GET STARTED!

VARIETY OF KITS AVAILABLE



- Industry's leading manufacturer of quality beekeeping supplies
- Experienced sales team that can help no matter your skill level
- Hives and hive kits, tools, protective clothing, queen rearing equipment, beekeeping tools, mite controls, honey extraction equipment, honey bottling supplies, and more!

NOW OFFERING POULTRY EQUIPMENT



MANN LAKE
WE KNOW BEES



800-880-7694
www.mannlakeltd.com

*Free shipping applies to most orders over \$100 sent standard ground service within the lower 48 states.

2019

EAS CONFERENCE

WELCOME TO
GREENVILLE
CONVENTION
CENTER



GREENVILLE, SOUTH CAROLINA!



WELCOME!! I, along with the South Carolina beekeepers, hope your EAS 2019 conference will provide what you are expecting. What are you expecting?

The EAS conference means different things to different attendees. There are so many moving pieces that dedicated volunteer beekeepers have been working on now for much of the year, that we set a pretty high bar so we can indeed meet your expectations. Don't hesitate to let us know how we did.

We annually seek to include the best bee biologists on our Short Course and Conference program. We have not conquered the bees but as we continually seek to understand them, it affords us the opportunity to become better informed beekeepers. We also seek to include the best, most knowledgeable "local" beekeepers to listen and learn from. Beekeeping is both science and art and in reality beekeeping really is all local. We also seek to include those that serve our beekeeping in numerous ways because we know the attendees are keeping bees differently in different seasons and for different purposes.

Do not neglect to learn from each other as well as our program people. A broad wealth of talent comes to EAS each year. During breaks, while sharing meals, attending social events and throughout the conference, go up to our presenters and ask them the question you didn't have a chance to ask during their talk or workshop. Just as important, talk with your fellow beekeepers because they too might help in your own personal journey through this thing termed apiculture. I find I learn from many discussions I have during the meeting and even after 53 years of attending (most) EAS conferences, I know I still have much I can learn from talking with and listening to others.

You will find during the short course/conference the volunteers with the shirts and badge ribbons helpful with local information and conference mechanics. Be sure to thank them. The vendors will be at their booths long hours and are a wealth of knowledge about many aspects of beekeeping. They help financially insure meeting success so don't neglect to thank them with purchases during and/or following our conference. Be sure to look at the honey show. You too can be a show entrant at a future EAS meeting if you did not enter this year. I guarantee that it will make you a better beekeeper as you prepare bee products for a show.

I encourage you to participate in the auctions. Those funds also support a successful conference. And the auctions are just fun. Did you bring honey to exchange? No! Why NOT? Look at the variety and colors and all for the price of exchanging your prized bee products with fellow beekeepers, who will appreciate your good jar of honey just as much as you might like to try a honey from someone else. What you didn't produce enough to have some to enter? Well we have speakers who can help this season and into the future tell/show you how. Any show entrant can tell you how they were able to prepare a show entry.

There is so much else to do and see and talk over with fellow beekeepers at an EAS conference. We are hoping to meet your meeting expectations so we encourage you to talk and listen and participate too. Most of all the South Carolina beekeepers extend you a most cordial welcome and howdee! We are glad you are here. We have enjoyed our time and effort in putting this conference together. Let's ENJOY EAS 2019 together.

Dewey M. Caron
Program Co-Chair



ORGANIC VARROA CONTROL



FORMICPRO

FOR TREATMENT OF VARROOSIS
CAUSED BY VARROA DESTRUCTOR IN HONEY BEES (APIS MELLIFERA)

**MANAGE
YOUR MITES
NATURALLY**

**FAST &
EFFECTIVE
14 DAY
TREATMENT**

TO LEARN MORE
VISIT OUR WEBSITE
[NODGLOBAL.COM/
FORMIC-PRO](http://NODGLOBAL.COM/FORMIC-PRO)



WATCH FOR OUR
**NEW BOXES &
RESEALABLE POUCHES**

Healthy Bees. Healthy Planet.

Available through beekeeping supply stores.
866-483-2929 | nodglobal.com
info@nodglobal.com



REGISTRATION, MEALS AND MORE

By Pamela Fisher

MEALS

Breakfast is on your own at your choice of lodging. We are offering boxed lunches for \$19 each at the convention center. All boxed lunches include a sandwich, choice of beverage, chef's choice of side salad (potato, pasta, orzo, vegetable, etc.), potato chips and a cookie. Vegetarian options are available. If you did not order your boxed lunch when you registered, we will have a very limited number of extra lunches available for purchase. Check the registration desk for availability.

Dinner is also on your own Monday and Tuesday which is a great opportunity to explore the many restaurants in downtown Greenville. With over 100 dining options, Greenville has a restaurant to fit every taste and budget. If you are staying at the Hilton, avail yourself of their shuttle which is a free transportation service within a 5-mile radius of the hotel.

Our Wednesday dinner is \$30 per person by ticket. The Southern Buffet features chicken barbecue with a choice of South Carolina's signature mustard-based sauce or Apple-infused sauce and all you care to eat of traditional side dishes including coleslaw, macaroni & cheese, potato salad, green beans, rolls, and cookies. Beverages include sweet tea, unsweetened tea and water as well as a cash bar. Live entertainment will be provided by the West End String Band, a local Greenville Americana, folk and bluegrass band, for a true South Carolina experience. If you did not purchase the Wednesday Dinner when you registered, we may have a few extra dinner tickets available for purchase on a first come basis. Check the registration desk for availability.

Our Thursday Auction Dinner is \$40 per person by ticket and features a buffet of both Chicken Marsala and Pasta Primavera (vegetarian), Garden Salad with Italian or Ranch dressing, Chef's Selection of Starch and Seasonal Vegetable, Rolls with Butter, Coffee, Tea and Water plus a dessert of both Blondies and Brownies. A cash bar is open the entire evening. Tickets were available through preregistration. Please check with the registration desk for availability if you did not preorder tickets to the dinner and would like to attend.

Our Friday Annual Banquet is a plated dinner at \$50 per person by ticket and features your choice of entrée. Choose from Herb Marinated Chicken Breast fire roasted with a Chablis plumped sundried tomato veloute; Fire Roasted Flank Steak, a house recipe marinated with a forest mushroom demi-glace; or Vegetable Crepes stuffed with garden vegetables and ricotta in house-made Pomodora sauce (vegetarian). Dessert is a choice of New York Cheesecake or Triple Chocolate Mousse Cake. All plated dinners include a Garden Salad with Italian or Ranch dressing, Chef's Selection of Starch and Seasonal Vegetable, Roll with Butter, Coffee, Tea and Water. A cash bar will be open the entire evening. Tickets for the Friday dinner were available through preregistration. A few tickets may be purchased onsite; check with the registration desk for availability.

VENDORS

American Bee Journal/Dadant
dadant.com

American Containers
americancontainers.com

Bee Club Sales
beeclubsales.com

Bee Culture Magazine
beeculture.com

Bee Hive Thermal Industries
beehivethermalindustries.com

BEEpothecary
mkt.com/beeepothecary

Better Bee
betterbee.com

Books and More

BroodMinder
broodminder.com

Charleston Community Bee Gardens
& Charleston Area Beekeepers
[scstatebeekeepers.com/venue/
charleston-community-bee-gardens/](http://scstatebeekeepers.com/venue/charleston-community-bee-gardens/)

Cindy Lackore Hand Sculpted Glass
& Jewelry
cindylackore.com

Dadant and Sons
dadant.com

Flow
honeyflow.com

Gold Star Honeybees
goldstarhoneybees.com

Healthy Bees LLC
healthybeesllc.com

Honey Bee Health Coalition
honeybeehealthcoalition.org

Honeycomb Hives
honeycombhives.com

Johnson's Bees and Supplies LLC
johnsonsbeesandsupplies.com

Little Mule Bee Supply
littlemulebee.com

Mann Lake Ltd
mannlakeltd.com

Millerbees Mfg.
beetlejail.com

NOD Apairies Products Ltd.
nodglobal.com/usa

The Nat Hive
twoqueenhive.com

OxaVap LLC
oxavap.com

Pigeon Mountain Trading Company
pigeonmountaintrading.com/

Pollinator Stewardship Council
pollinatorstewardship.org

Reeds Apiary and Bee-tique

Riverwood Inc
riverwood.com.pk/bees

Rose Micro Solutions
rosemicrosolutions.com

Rossman Apiaries
gabees.com

Solution Bee
solutionbee.com

Southeast Bee Supply
[panjiva.com/Southeast-Bee-
Supply/41549213](http://panjiva.com/Southeast-Bee-Supply/41549213)

The Hive Butler, LLC
www.thehivebutler.com

The Rose Gardner

USDA NASS
www.nass.usda.gov

Veto-Pharma
veto-pharma.com





GREENVILLE CONVENTION CENTER FLOORPLANS

The Greenville Convention Center is laid out on two levels. Level 1 provides lecture rooms 100 - 104. The Short Course sessions will take place in these lecture rooms (and Apiary) with breakouts into the Courtyard and Public Areas.

Each Conference day will begin in the front half of the Ballroom on Level 2. Afternoon sessions will be held in the lecture rooms on Level 1 (and the Apiary).

The back of the Ballroom will be the site of the Vendor Hall! Our Vendors, listed on page XX, will be open from mid-morning Tuesday through Friday to demonstrate their products and provide information and advice to bee enthusiasts of all levels.

Exhibit Hall - LEVEL 1

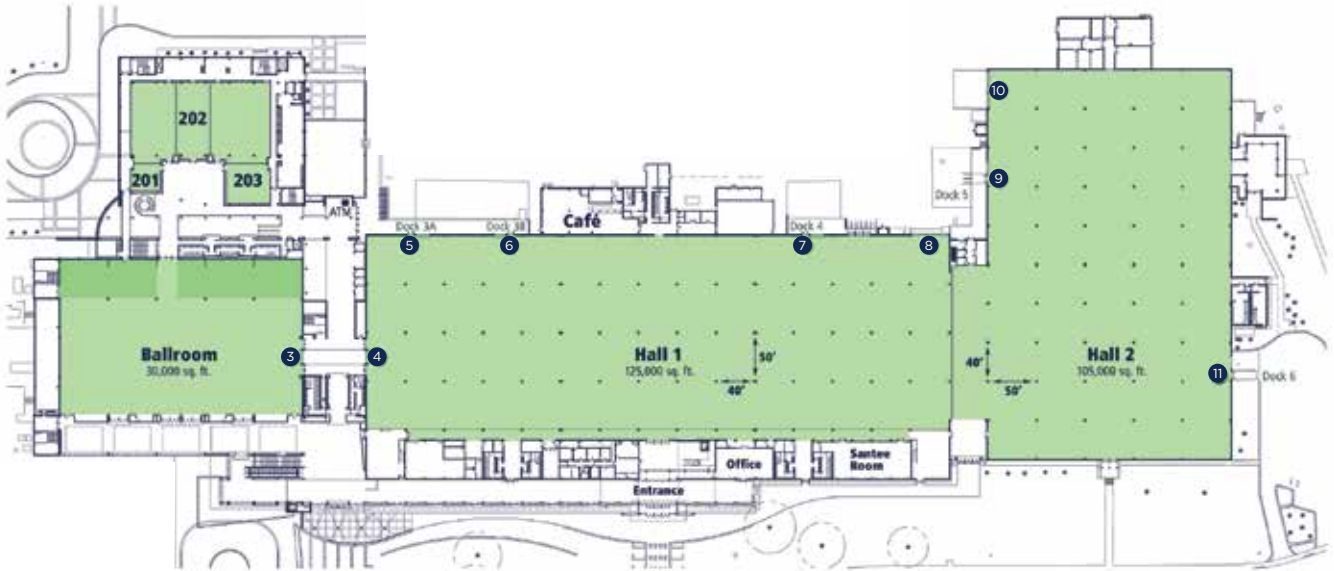
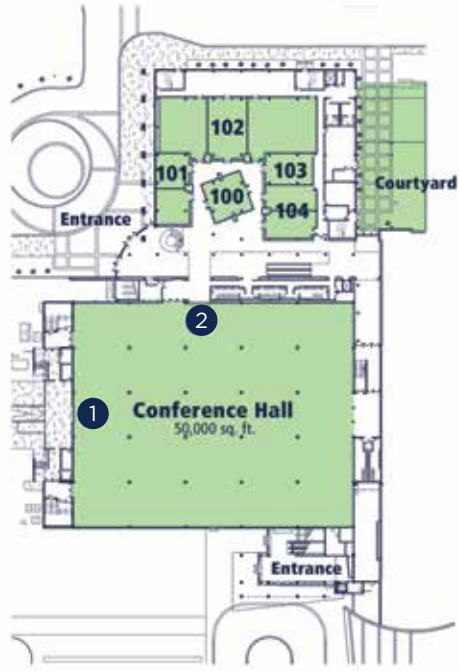

GREENVILLE CONVENTION CENTER PARKING & FACILITY ACCESS



Extensive free parking is available for conference participants. The main entrance to the convention center is off Eisenhower Drive with further access off Exposition Drive.

SUNDAY JULY 14, 2019 REGISTRATION OPEN 4:00-7:00 PM

Short Course Schedule

Schedule may be subject to minor changes.

MONDAY, JULY 15

LEVEL	BEGINNER	INTERMEDIATE	ADVANCED	Intermediate - Advanced	Queen & colony Management	APIARY
ROOM/TIME	104 A	104 B	102 A	102 B	102 C	
8:30-9:25	Beekeeping Basics – What do You Absolutely Need? Walt Perrin, SC	Challenges of Changing Beekeeping EAS MB Steve Repasky, PA	Profitable Bee Business –Honey Packaging & Labeling Freddy Proni, NC	The Enigma of Nosema- Exploring Our “Invisible” Disease. Dorinda Priebe, NH	Using Queen Castles to Increase Honey Production George McAllister, NC	
9:25	10 min Stretch Break					
9:35-10:30	BEE BASICS – Starting a New Hive Jennifer Lund, ME	The Frame Game – Tales of Mixing and Matching Kevin Inglin, NJ	Finances of Bees David MacFawn, SC	Beekeeping Agrotourism Kerry Owen, SC	Classic Doolittle Cell Building Discussion GO TO APIARY Greg Rogers, NC	Doolittle Cells and Queen Rearing Greg Rodgers, NC
10:30	30 Min Break					
11:00-12	GO TO APIARY	To Feed or Not to Feed, and Why, When, and How Landi Simone, NJ	Appalachian Beekeeping Collective of WV Cindy Bee, WV	Honey Bee Waste Management Walt Perrin, SC	Treat Smarter & Feed More Surviving in Age of Mite Bombs & Severe Weather Greg Rogers, NC	BEE BASICS for Beginners EAS Bee Wrangler & Dr Weir, SC
12:00-1:30	90 Min Lunch Break Rm 202C - Master Beekeepers, Meet and Greet, 1:30-3:00pm Q & A + Study					
LEVEL	BEGINNER	INTERMEDIATE	ADVANCED	INTERMED-ADVANCED	Queen Rearing	APIARY
ROOM/TIME	104 A	104 B	102 A	102 B	102 C	
1:30-2:25	Basics of Bee Biology Cindy Hodges, GA	GO TO APIARY	Producing & Processing Honey Danny Cannon, SC	Sustainability in Beekeeping Erin Forbes, ME	Determining the Status of the Queen Rick Coor, NC	Bee Basics Wranglers David Weir, SC
2:25	10 min Stretch Break					
2:35 - 3:35	Reading Brood/Honey Frames Staci Siler, SC	Pollination Glenn Tyler and Wes Bonner, SC	Bee Products Making the Most of the Cool Stuff Your Bees Make Landi Simone, NJ	Strategies for Success with Brood Nest David Arnal, SC	Mating Yard Set Up and Maintenance Rick Coor, NC	Monitor for Varroa in Bee Yard w/ Brad Cavin & Lewis Cauble SC/NC inspectors
3:35	30 min Break					
4:05-5:00	Putting It All Together – Discussion Panel of 3 Walt Perrin, Staci Siler & Cindy Hodges	Should You Incorporate Justin Kay, NC	How to Find Good Nectar Harvests Danny Cannon, SC	Splits & Varroa EAS MB Bill Hesbach, CT	GO TO APIARY Queen Castles for Honey Production G. McAllister, NC	Queens in the Bee Yard w/ Rick Coor, NC
6:00	Dinner on your own; Greenville tour					

Short Course Schedule

Schedule may be subject to minor changes.

TUESDAY, JULY 16

TUESDAY JULY 16 REGISTRATION OPENS 7:30 – CONTINUES ALL DAY

LEVEL	BEGINNER	INTERMEDIATE	ADVANCED	Queen Rearing	Master Bee-keepers	APIARY
ROOM/ TIME	104 A	104 B	102 A	102 B	201	
8:30-9:25	Challenges Keeping Bees Around People/Family/Animals EAS MB Steve Repasky, PA	GO TO APIARY	Varroa Sampling Meghan McConnell, DE	Into to Queen Rearing Jen Berry, GA	Written Exam	Apiary Part 2 Intermediates
9:25	10 minute stretch break					
9:35-10:30	Seasonal Management Glenn Tyler, SC	Nucs the Next Step EAS MB Bob Kloss, NJ	Miticide Application: Do's and Don'ts Lewis Cauble, NC	Queens (continued) APIARY SESSION Jen Berry	Written Exam (continued)	Queens with Jen Berry
10:30	30 minute break					
11:00-12:00	GO TO APIARY	Handling Bees with an Attitude Steve Genta, SC	Using a Resource Hive Dewey M. Caron, OR	Queens (continued) Jen Berry	Written Exam (to 12:30 p.m.) Oral Exams Begin in Room 101 A,B and 100 A	Apiary part 2 Starting w/ Bees Smoker & Hive Tool Basics Jen Lund, ME
12:00-1:30	LUNCH					
LEVEL	BEGINNER	INTERMEDIATE	ADVANCED	Queen Rearing	Master Beekeepers	APIARY
ROOM/ TIME	104 A	104 B	102 A	102 B	101 A,B, 100 A	
1:30-2:25	Benefitting From Beginner Beekeeping Blunders Landi Simone, NJ	Teaching Apiaries Using MP 3 and BMPs Meghan McConnell, DE	Bee Nutrition Mary Cahill-Roberts, AL	Queens (continued) Jen Berry	Oral Exams (continued)	Nucs/Splits with James Alverson, SC
2:25	10 minute stretch break					
2:35-3:30	Mites 101 Lewis Cauble, NC Bee Inspector	Safety/Sanitation in Apiary and Honey House Danny Cannon, SC	Thermo-regulation and the Condensing Colony Bill Hesbach, CT	Queen Rearing Wrap Up (continued) Jen Berry	Oral Exams (continued)	Top bar hives with Chris Rucker SC
3:30	30 minute break					
4:00-5:00	Putting it all Together Discussion Moderator Jen Lund, ME	Bee Cutouts/Transfers Cindy Bee, WV	Comb Honey Production - A Boutique Addition to the Apiary Mary Cahill-Roberts, AL	Local Selection Adam Finkelstein, SC TENTATIVE	Oral Exams (continued)	Apiary Discussion With EAS Master Beekeepers + Bee Wranglers
6:00	Informal Event – visit local brewery					

Short Course and Conference Schedule

Schedule may be subject to minor changes.

WEDNESDAY, JULY 17

7:30	Registration opens continuing all day					
8:30	EAS Master beekeeper Lab test; Field exams begin 10:45 continuing in afternoon					
8:30-8:45	EAS Conference Opening and Introductions (Buddy May, SC Presiding), Ballroom Level 2					
8:45-9:15	KEYNOTE 1 Dewey Caron - Best Management Practices					
9:15-9:45	Matthew Mullica - Honey Bee Health Coalition					
9:45-10:45	KEYNOTE 2 Roger A. Morse Extension, Regulatory Teaching Award – Jennifer Berry, Oxalic acid trials (and tribulations) - Go with what we know works					
10:00	Self-guided tours of Heritage Green, Greenville					
10:45-11:15	30 MIN Break – visit vendors; Honey Show entries; show closed for judging all afternoon					
11:15-12:00	<i>Special Invited presentation: Mike Gardner, Spell Bee – 51 years later – I’m still learning</i>					
12:00-1:30	LUNCH 202C					
TRACK	Microbes and B sex	Programs on Bees	Bee Health	Beekeeping	Zika and bees	Master Beekeeper
ROOM/ TIME	104 A	104 B	102 A	102 B	102 C	
1:30-2:30	Future of Microbials Jay Evans, USDA	NC Born & Bred Queen Program Rick Coors, NC	Foulbrood Disease in Honey Bee Colonies Meghan Milbrath, MI	Encouraging Propolis Collection for Healthier Bees Cindy Hodges, GA	Beekeeping in the Era of ZIKA David Arnal, SC	Field exams (continued)
2:30	30 min BREAK: Vendors close at 3 PM					
3:00-4:00	What We Need to Know About Bee Viruses Lewis Bartlett, GA	NH Honey Bee Diagnostic Network Dave Priebe, NH	Beekeepers as Environmental Advocates Stuart Anderson flow Hive inventor Australia	Small Scale Apiary - 5-15 Colonies James Alverson, SC	Pesticide Issues in SC Brad Cavin SC Apiary Inspector or Pesticides Division rep	Field exams (continued)
4:00	10 min stretch break					
4:10-5:10	Honey Bee Flight & Sexual Reproduction Bill Hesbach, CT	Reaching Unique Beekeepers Wes Bonner, SC & Jen Berry, GA	Comparison of 4 Management Systems Justin Kay, NC	Appalachian Beekeeping Collective Cindy Bee, WV	Bee Toxic Pesticides Impact on Bee Forage, Mosquito Control, and Stakeholder Communication Michele Colopy, Stewardship Council, OH	
6:30	Cash bar and Dinner at Hilton Hotel					

Conference Schedule

Schedule may be subject to minor changes.

THURSDAY, JULY 18

2019 EAS ANNUAL CONFERENCE THURSDAY JULY 18	
All day	Registration; honey show open; silent auctions, honey exchange
8:30-8:45	Opening and Introductions David MacFawn Program co-chair presiding , Ballroom Level 2
8:45-9:40	KEYNOTE 1: Kirsten Traynor, MD – 2 million blossoms –Protecting our Pollinators
	10 min stretch break
9:50-10:40	KEYNOTE 2: Jay Evans, USDA- Genes, Germs, and Stress: Helping bees to help themselves
10:40	30 min break
11:10-12:00	J.I. HAMBLETON RESEARCH AWARD: Reed Johnston, Ohio State Univ. Solving Problems at the Intersection between Bee Foraging and Pesticide Application
12:00-1:30	LUNCH
12:15	Registrants for tour to Bee Well Honey Farm board busses

TRACK	Special presentations	Honey Bee Health	Keynoters Encore	Pollination	Apiary	Honey show	Tours/spec programs
ROOM/TIME	104 A	104 B	102 A	102 B		202 B	101 B
1:30-2:30	Varroa Mite Impacts on Queen Quality and Genetic Diversity in the Hawaiian Islands. Lauren Rusert, NC State Student Award Winner	Small Hive Beetle A to Z Mike Hood, SC	Good Science in Your Backyard: How to Test New Products for Varroa Control Kirsten Traynor. MD	Pollination Finance David MacFawn, SC	Open Apiary with Bee Wrangler	Judging Results - Why Winners Won Honey Show Chair Steve Genta, SC	Bee Well Honey Farm tour 12:15-5:00pm
2:30	30 min Break –Visit Vendors						
3:00-4:00	Polyandry - The Neglected Step-child of Bee Breeding Keith Delaplane, GA	The Enigma of Nosema- Exploring our Understanding of an Invisible Disease. Dorinda Priebe, NH	Novel Control Strategies for Bee Viruses. Jay Evans USDA, MD	Pollination in SC Glenn Tyler &/or Wes Bommer SC	Small Hive Beetle in Practice Mike Hood, SC	Honey Show Open (continued)	
4:00	10 min Stretch Break						
4:10-5:10	An Overview of Honey Bee Pesticide Testing and Regulatory Toxicology Reed Johnson. J.I. Hambleton Winner	Bee Sex and Neonicotinoids Goeff Williams, AL	Splits for Swarm Control Meghan Milbreath. MI	Beyond Honey Bees: A World of Other Pollinators Jon Zawislak, AR	Testing for Nosema Show and Tell Dave & Dorinda Priebe, NH	Honey Show Open (continued)	
6:30	Hilton Hotel Buffet meal; Honey show winners; Benefit Auction						

Conference Schedule

Schedule may be subject to minor changes.

FRIDAY, JULY 19

8:30	Registration open until noon; honey show & Vendors open until after lunch
8:30	Opening and Introductions Dewey Caron, Program co-chair presiding , Ballroom Level 2
8:35	KEYNOTE 1 Meghan Milbrath, MI The Greatest Generation: protecting our winter bees
9:35	KEYNOTE 2 Geoff Williams, AL What BeeInformed Survey says about Bee Health
10:25	25 min BREAK – last chance to visit vendors – they breakdown following lunch
10:50-11:10	Honey Princess – Nicole Medina, NJ Maine Promo - Peggy McLaughlin, ME
11:30	EAS Member Meeting

	Award winners II	Bee Health	Bees around the globe	Our hosts	Apiary	
ROOM/ TIME	104 A	104 B	102 A	102 B		101 A
1:30-2:30	Stressor Interactions: When Parasites & Pesticides Collide Geoff Williams, AL	Its all About "Jeans" (DNA) Fleming Mattox, SC	Beekeeping in Lithuania David Arnal, SC	Lighter Side of Beekeeping Mike Hood, SC	Last Chance for Apiary Bee wranglers	
2:30	30 min Last Break; Pick up Honey Show entries					
3:00-4:00	Beekeeping in Paradise Lauren Rusert EAS Student award winner	What Bees in Nature Can Teach Us About Colony Health Keith Delaplane, GA	Beekeeping Support in Malawi Bob Kloss, NJ	Cut colony loss with proper bee nutrition Lee Rosen, CEO Healthy Bees		MB Exams Reviews Deb Delaney, DE
4:00-5:00	Honey as Medicine: What Does the Science Say? Kirsten Traynor, MD	Common Beekeeper Mistakes Jon Zawislak, AR	Audience Sharing of Bee Travel Stories	Interpretative Bee Program Marvin Bouknight Discovery Place Nature Charlotte, NC		
6:00	Banquet at Hilton Hotel: MB Awards & Thanks, Bee Tales Dewey Caron					

AMERICAN HONEY PRINCESS

Nicole Medina, the 2019 American Honey Princess, will visit Greenville, SC July 15-19. She will be a guest speaker at the Eastern Apicultural Society conference, speaking to attendees about the importance of honey bees to Texas agriculture and how honey bees drive the quantity and quality of our food. She will also share information about the bonuses that honey bees provide beyond honey

Nicole is the 20-year-old daughter of Joel and Nolvía Medina of Green Township, New Jersey. She is a sophomore at Sussex County Community College studying business administration. Nicole has been keeping bees for five years with her family and is an active volunteer in the Sussex County Beekeepers Association.

As the 2019 American Honey Princess, Nicole serves as a national spokesperson on behalf of the American Beekeeping Federation, a trade organization representing beekeepers and honey producers throughout the United States. The American Honey Queen and Princess speak and promote in venues nationwide, and, as such Princess Nicole will travel throughout the United States in 2019. Prior to being selected as the American Honey Queen, Nicole served as the 2018 New Jersey Honey Queen. In this role, she promoted the honey industry at fairs, festivals, and farmers' markets, via media interviews, and in schools.

The beekeeping industry touches the lives of every individual in our country. In fact, honey bees are responsible for nearly one-third of our entire diet, in regards to the pollination services that they provide for a large majority of fruits, vegetables, nuts and legumes. This amounts to nearly \$19 billion per year of direct value from honey bee pollination to United States agriculture.

For more information on Princess Nicole's South Carolina visit and to schedule an interview, contact Buddy May at 864.430.0318.



SPEAKER SCHEDULE

JAMES ALVERSON

- Tuesday 1:30 PM to 2:25 PM | Location: Apiary
Nucs And Splits
- Wednesday 3:00 PM to 4:00 PM | Location: Rm. 102B
Small Scale Apiary - 5 to 15 Colonies..



STUART ANDERSON

- Wednesday 3:00 PM to 4:00 PM | Location: Rm. 102A
Beekeepers As Enviromental Advocates



DAVID ARNAL

- Monday 2:35 PM to 3:35 PM | Location: Rm. 102B
Strategies For Success With Brood Nest Configuration
- Wednesday 1:30 PM to 2:30 PM | Location: Rm. 102C
Beekeeping In The Era Of Zika
- Friday 1:30 PM to 2:30 PM | Location: Rm. 102A
Beekeeping In Lithuania



LEWIS BARTLETT

- Wednesday 3:00 PM to 4:00 PM | Location: Rm. 104A
What We Need To Know About Bee Viruses



CINDY BEE

- Monday 11:00 AM to 12:00 AM | Location: Rm. 102A
Appalachian Beekeeping Collctive of West Virginia
- Tuesday 4:00 PM to 5:00 PM | Location: Rm. 104B
Bee Cutouts & Transfers
- Wednesday 4:10 PM to 5:10 PM | Location: Rm. 102B
Appalachian Beekeeping Collective



JENNIFER BERRY

- Tuesday, Jennifer presents a day-long queen rearing course
- Wednesday she is a featured keynote speaker.



WES BOMMER

- Wednesday 4:10 PM to 5:10 PM | Location: Rm. 104B
Reaching Unique Beekeepers
- Thursday 3:00 PM to 4:00 PM | Location: Rm. 102B
Pollination in South Carolina



MARVIN BOUKNIGHT

- Friday 4:00 PM to 5:00 PM | Location: Rm. 102B
Interpretative Bee Program



MARY CAHILL-ROBERTS

- Friday 4:00 PM to 5:00 PM | Location: Rm. 102B
Interpretative Bee Program



DANNY CANNON

- Monday 1:30 PM to 2:25 PM | Location: Rm. 102A
Producing & Processing Honey
- Monday 4:05 PM to 5:00 PM | Location: Rm. 102A
How To Find Good Nectar Harvests
- Tuesday 2:35 PM to 3:30 PM | Location: Rm. 104B
Safety & Sanitation in The Apiary And Honey House



LEWIS CAUBLE

- Monday 2:35 PM to 3:35 PM | Location: Apiary
Monitoring For Varroa In The Bee Yard
- Tuesday 9:35 AM to 10:30 AM | Location: Rm. 102A
Miticide Application: Do's and Don'ts
- Tuesday 2:35 PM to 3:30 PM | Location: Rm. 104A
Mites 101



BRAD CALVIN

- Monday 2:35 PM to 3:35 PM and other times | Location: Apiary
Monitoring For Varroa In The Bee Yard
- Wednesday 3:00 PM to 4:00 PM | Location: Rm. 102C
Pesticide Issues in South Carolina



MICHELE COLOPY

- Wednesday 4:10 PM to 5:10 PM | Location: Rm. 102C
Bee Toxic Pesticides Impact On Forage, Mosquito Ctrl & Stakeholder Comms



RICK COOR

- Monday 1:30 PM to 2:25 PM | Location: Rm. 102C
Determining The Status Of The Queen
- Monday 2:35 PM to 3:35 PM | Location: Rm. 102C
Mating Yard: Set Up & Maintenance
- Monday 4:05 PM to 5:00 PM | Location: Apiary
Queens In The Bee Yard
- Wednesday 1:30 PM to 2:30 PM | Location: Rm. 104B
North Carolina Born & Bred Queen Program



KEITH DELAPLANE

- Thursday 3:00 PM to 4:00 PM | Location: Rm. 104A
Polyandry - The Neglected Step Brother Of Bee Breeding
- Friday 3:00 PM to 4:00 PM | Location: Rm. 104B
What Bees In Nature Can Teach Us About Colony Health



MIKE GARDNER

- SPECIAL INVITED PRESENTATION
- Wednesday 11:15 AM to 12:00 AM | Location: Rm. 200 (Ballroom)
Spell Bee - 51 Years Later - I Am Still Learning



STEVE GENTA

- Tuesday 11:00 AM to 12:00 AM | Location: Rm. 104B
Handling Bees With An Attitude
- Thursday 1:30 PM to 2:30 PM | Location: Rm. 202B
Honey Show Judging Results: Why Winners Won.



BILL HESBACH

- Monday 4:05 PM to 5:00 PM | Location: Rm. 102B
Splits & Varroa
- Tuesday 2:35 PM to 3:30 PM | Location: Rm. 102A
Thermoregulation And The Condensing Colony
- Wednesday 4:10 PM to 5:10 PM | Location: Rm. 104A
Honey Bee Flight & Sexual Reproduction



CINDY HODGES

- Monday 1:30 PM to 2:25 PM | Location: Rm. 104A
Basics Of Bee Biology
- Monday 4:05 PM to 5:00 PM | Location: Rm. 104A
Putting It All Together: Discussion Panel
- Wednesday 1:30 PM to 2:30 PM | Location: Rm. 102B
Encouraging Propolis Collection for Healthier Bees



MIKE HOOD

- Thursday 1:30 PM to 2:30 PM | Location: Rm. 104B
Small Hive Beetle A To Z
- Thursday 3:00 PM to 4:00 PM | Location: Apiary
Small Hive Beetle In Practice
- Friday 1:30 PM to 2:30 PM | Location: Rm. 102B
Lighter Side Of Beekeeping



DON HOPKINS

BEE WRANGLER
Find Don in the apiary all week



Location: Rm. 200 (Ballroom)
Opening And Introductions

- Thursday 1:30 PM to 2:30 PM | Location: Rm. 102B
Pollination Finance

KEVIN INGLIN

• Monday 9:35 AM to 10:30 AM |
Location: Rm. 104B
The Frame Game



ERIN MACGREGOR-FORBES

• Monday 1:30 PM to 2:25 PM |
Location: Rm. 102B
Sustainability In Beekeeping



JUSTIN KAY

• Monday 4:05 PM to 5:00 PM |
Location: Rm. 104B
Should You Incorporate?
• Wednesday 4:10 PM to 5:10 PM
| Location: Rm. 102A
*Comparison Of Four
Management Systems*



FLEMING MATTOX

• Friday 1:30 PM to 2:30 PM |
Location: Rm. 104B
It's All About 'Jeans' (DNA)



GEORGE MCALLISTER

• Monday 8:30 AM to 9:25 AM |
Location: Rm. 102C
*Using Queen Castles To Increase
Honey Production*
• Monday 4:05 PM to 5:00 PM |
Location: Rm. 102C
Queen Castles For Honey Production



BOB KLOSS

• Tuesday 9:35 AM to 10:30 AM |
Location: Rm. 104B
Nucs, The Next Step EAS MB
• Friday 3:00 PM to 4:00 PM |
Location: Rm. 102A
Beekeeping Support in Malawi



MEGHAN MCCONNELL

• Tuesday 8:30 AM to 9:25 AM |
Location: Rm. 102A
Varroa Sampling
• Tuesday 1:30 PM to 2:25 PM |
Location: Rm. 104B
*Teaching Apiaries Using MP3s
and BMPs*



JENNIFER LUND

• Monday 9:35 AM to 10:30 AM |
Location: Rm. 104A
Bee Basics: Starting A New Hive
• Tuesday 11:00 AM to 12:00 AM
| Location: Apiary
*Starting With Bees: Smoker and
Hive Tool Basics*
• Tuesday 4:00 PM to 5:00 PM | Location: Rm. 104A
Putting It All Together (Discussion)



NICOLE MEDINA

• Tuesday Children's program
• Wednesday Honey judge
• Thursday Life Member
luncheon + Auction
• Friday 11:10 AM to 11:30 AM |
Location: Rm. 200 (Ballroom)
Honey Princess Report



DAVID MACFAWN

• Monday 9:35 AM to 10:30 AM |
Location: Rm. 102A
Finances of Bees.
• Thursday 8:30 AM to 8:45 AM |





HEART & SOUL

A family of beekeepers producing superior beekeeping supplies.

The lines on our skin hint at our age. Our backs ache, our knees creak and every morning we take that first step out of bed unsure if our legs will hold, but they do.

Our tools are covered in wax and propolis from decades of use. We clean them from time to time but our smoker's bellows still push calming puffs out and that's all that matters.

We're not new to this like some. We've seen 'em come and go over the decades. When you've been in the game this long you're bound to say goodbye to old friends from time to time.

Yet, after all these years there's still no quit in us. We pour our heart and soul into it, it's our livelihood and we wouldn't want it any other way.



Are you ready to see what over 150 years of experience can do?
Contact us today and let Dadant help.



Online dadant.com | Toll-Free 888.922.1293

HARRY L. OTT, JR.

- Wednesday 8:30 AM to 8:45 AM | Location: Rm. 200 (Ballroom)
Introductory Remarks



KERRY OWEN

- Monday 9:35 AM to 10:30 AM | Location: Rm. 102B
Beekeeping Agrotourism
- Thursday afternoon Visit Kerry's bee shop and bees on tour



WALT PERRIN

- Monday 8:30 AM to 9:25 AM | Location: Rm. 104A
Beekeeping Basics: What Do You Absolutely Need?
- Monday 11:00 AM to 12:00 AM | Location: Rm. 102B
Honey Bee Waste Management
- Monday 4:05 PM to 5:00 PM | Location: Rm. 104A
Putting It All Together: Discussion Panel



DAVE PRIEBE

- Wednesday 3:00 PM to 4:00 PM | Location: Rm. 104B
New Hampshire Honey Bee Diagnostic Network
- Thursday 4:10 PM to 5:10 PM | Location: Apiary
Testing For Nosema: Show & Tell



DORINDA PRIEBE

- Monday 8:30 AM to 9:25 AM | Location: Rm. 102B
The Enigma Of Nosema: Exploring Our Understanding Of An Invisible Disease
- Thursday 3:00 PM to 4:00 PM | Location: Rm. 104B
The Enigma Of Nosema: Exploring Our Understanding Of An Invisible Disease
- Thursday 4:10 PM to 5:10 PM | Location: Apiary
Testing For Nosema: Show & Tell



FRED PRONI

- Monday 8:30 AM to 9:25 AM | Location: Rm. 102A
Profitable Bee Business: Honey Packaging and Labeling



STEVE REPASKY

- Monday 8:30 AM to 9:25 AM | Location: Rm. 104B
Challenges of Changing Beekeeping
- Tuesday 8:30 AM to 9:25 AM | Location: Rm. 104A
Challenges: Keeping Bees In Proximity Of People, Family & Animals



GREG RODGERS

- Monday 9:35 AM to 10:30 AM | Location: Apiary
Classic Doolittle Cell Building Discussion
- Monday 11:00 AM to 12:00 AM | Location: Rm. 102C
Treat Smarter & Feed More: Surviving The Age Of Mite Bombs & Severe Weather



CHRIS RUCKER

- Tuesday 2:35 PM to 3:30 PM | Location: Apiary
Top Bar Hives



STACI SILER

- Monday 2:35 PM to 3:35 PM | Location: Rm. 104A
Reading Brood/Honey Frames
- Monday 4:05 PM to 5:00 PM | Location: Rm. 104A
Putting It All Together: Discussion Panel



LANDI SIMONE

- Monday 11:00 AM to 12:00 AM
| Location: Rm. 104B
To Feed Or Not To Feed: Why, When and How
- Monday 2:35 PM to 3:35 PM |
Location: Rm. 102A
Bee Products
- Tuesday 1:30 PM to 2:25 PM | Location: Rm. 104A
Benefitting from Beginner Beekeeper Blunders

**DAVID WEIR**

- Monday 11:00 AM to 12:00 AM
and 1:30-2:25 | Location: Apiary
Bee Basics: Beginners
- Tuesday all day Location:
Apiary
Bee Basics
- Thursday & Friday AM

Find David in
apiary**GLENN TYLER**

- Monday 2:35 PM to 3:35 PM |
Location: Rm. 104B
Pollination
- Tuesday 9:35 AM to 10:30 AM |
Location: Rm. 104A
Seasonal Management

**JON ZAWISLAK**

- Thursday 4:10 PM to 5:10 PM |
Location: Rm. 102B
*Beyond Honey Bees: A World of
Other Pollinators*
- Friday 4:00 PM to 5:00 PM |
Location: Rm. 104B
Common Beekeeper Mistakes



Johnson's Bees and Supplies
Beekeeping Equipment and Supplies
Queens, Nucs, and Spring Packages
Store Hours: Mon., Tues., Thurs., Fri. 10-5
and Saturday 10-2
Allen and Marie Johnson



Johnson's
Bees & Supplies

744 Tinker Creek Road
Williston, SC 29853

803-645-6725 or 803-645-0969
johnsonsbessupply.sc@gmail.com
www.johnsonsbessandsupplies.com

BEEpothecary

BEEpothecary harnesses the power of beehive resources in propolis supplements, skincare and shaving products. All of our products contain bee propolis, honey, beeswax and/or pollen, to capture their amazing, researched-based benefits. It's what makes our products unique!



BEEpothecary.US

 **FLOW**

Flow Hives make honey harvesting easier



Meet Flow
Hive Inventor
Stuart Anderson
at the Flow
stand

SPECIAL EVENT DISCOUNT CODE* EASFLOW10%

*Visit honeyflow.com to claim. Excludes: sale items, shipping, bundles & brood boxes. Expires midnight July 27, 2019.

Discover this award winning Australian invention at
honeyflow.com
+1 (646) 8768 880 | info@honeyflow.com

SPECIAL EVENT LINEUP

Monday, July 15

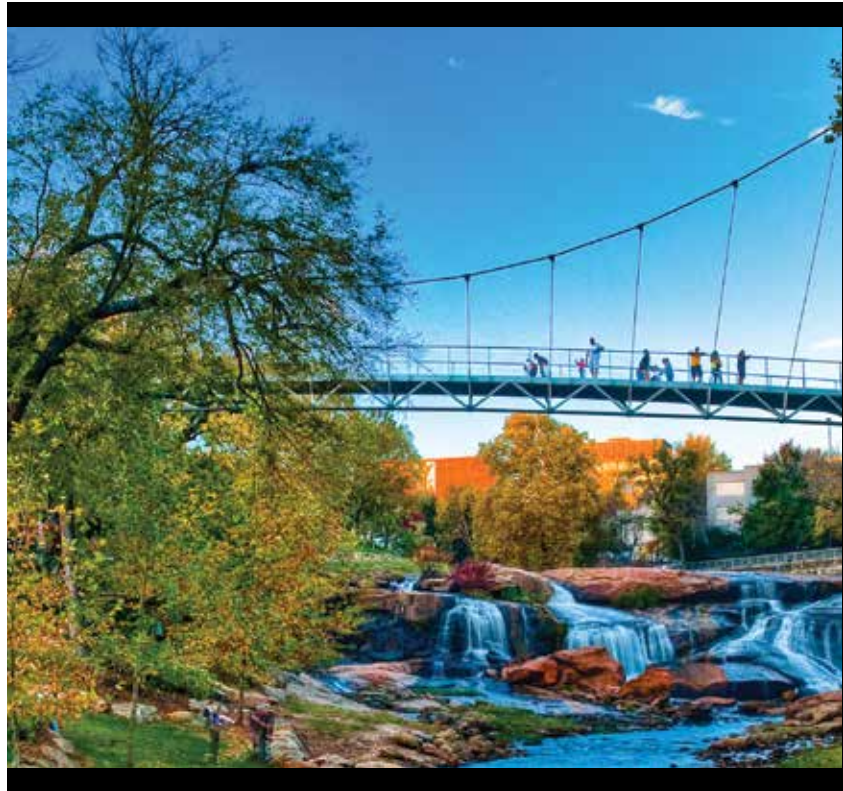

GREENVILLE HISTORIC WALKING TOUR

Monday 6:10pm - 7:30pm

Corner of Main Street and Fall Park Drive

Greenville opens to a local walking tour, led by John Nolan, author of *A Guide to Historic Greenville, SC.* Starting with views of the city from the pedestrian Liberty Bridge, attendees will receive a chronological history of the city's last 40 years of development. Dinner choices are plentiful in the area and provide options for every taste and budget. Check with the registration desk to see if any tickets (\$12) for the guided tour are still available.

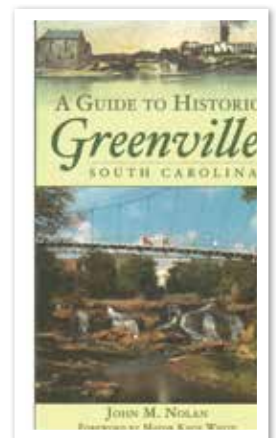

Tuesday, July 16

Wednesday, July 17

IRON HILL BREWERY & RESTAURANT

© 2019 Iron Hill Brewery & Restaurant.

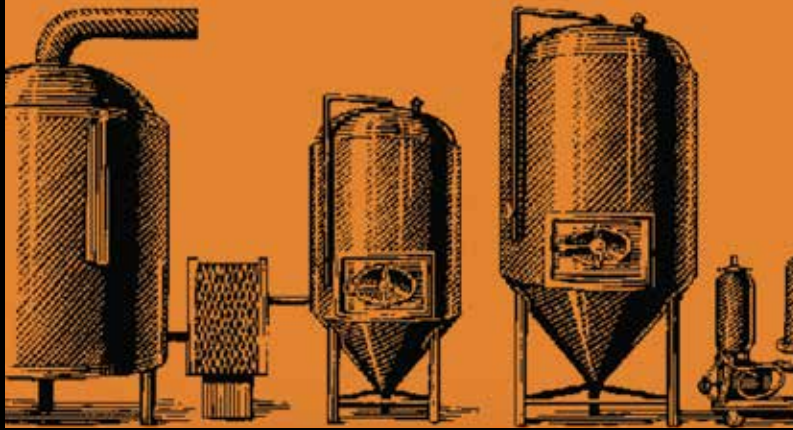

IRON HILL BREWERY TOUR AND RESTAURANT EVENING

Tuesday 6:00-9:00pm

741 Haywood Road, Greenville SC 29607

Transport yourself to this nationally acclaimed regional brewpub chain. Personal tours of the facility will be provided by the Brewmaster and will include 2-ounce samplers. The mid-priced Iron Hill Restaurant's craft kitchen features an eclectic menu including salads, signature soups, steakhouse favorites, vegetable sides and Brewhouse entrees, each with suggested beer pairings from over a dozen beers on tap. Gluten-allergen friendly meals are included on both the adult and kids' menus and vegetarian options are available. Desserts tempt our sweeter side!



MUSEUMS ON HERITAGE GREEN TOUR AND/OR VISITATION

Wednesday 10:00am-5:00pm

College and Buncombe Streets, Greenville SC 29601

Heritage Green is an urban arts and cultural campus located on College Street, just three blocks from the Hyatt Regency on Main Street. It is home to: 1. the Carolina Music Museum, 2. the Greenville Little Theatre, 3. The Children's Museum of the Upstate, 4. the Greenville County Museum of Art, 5. the Upcountry History Museum and 6. the Greenville County Library System Hughes Main Library. Open from 10:00 a.m., this enclave provides a wonderful point of discovery for a day in Greenville –something for every age and interest! Public parking abounds, so grab the family and make a day of it.

Thursday, July 18



SOUTHERN BUFFET, BEE OLYMPICS AND BAND

Wednesday 5:00pm-9:00pm

The Southern Buffet features chicken barbecue with a choice of South Carolina's signature mustard-based sauce or Apple-infused sauce and all you care to eat of traditional side dishes including coleslaw, macaroni & cheese, potato salad, green beans, rolls, and cookies. Beverages include sweet tea, unsweetened tea and water as well as a cash bar. As dinner winds down, the gloves will come off for some indoor Bee Olympics! Come try your hand at various bee-related skills on impromptu teams that will match each other in a good natured competition. Topping off the evening, live entertainment will be provided by the West End String Band, a local Greenville Americana, folk and bluegrass band, for a true South Carolina experience. If you did not purchase the Wednesday Dinner when you registered, we may have a few extra dinner tickets available for purchase on a first come basis. Check the registration desk for availability.

BEE WELL HONEY FARM

Thursday 12:15pm-5:00pm

Clemson University vans will provide transport to the Bee Well Honey Farm in Pickens, SC, approximately 25 miles from Greenville. We will be greeted by owners Kerry and Donna Owen who will present the Bee Well story as we enjoy lunch from a build-your-own sandwich buffet. The tour of Bee Well Honey Farm will include visiting the extraction, bottling, and distribution areas as well as the candle, soap and mead making facilities. There will be an opportunity to wander through their pollinator garden and browse through their two retail facilities. Check with the Registration Desk to see if any spots remain for this great tour.



THURSDAY SOCIAL, DINNER, AND AUCTION

Silent Auction - Thursday 2:30pm-6:00pm

Cash Bar - Thursday 5:00pm-9:00pm

Dinner - Thursday 6:30pm-8:00pm

Live Auction - Thursday 8:00pm-9:30pm

Who doesn't love a special find at a special price –made even more rewarding by the realization that the funds generated will be put to such good use in the bee world? Silent auctions will be held daily during the conference at the Greenville Convention Center providing opportunities to find small and medium items related to the bee world –something for your home, family, and friends. On Thursday, more substantial items will be offered in a silent auction setting followed by a live auction. Donated items range from state baskets, company and individual contributions, handcrafted items, and first place entries donated from the Honey Show. Items will be on display for perusal before the live bidding commences, so sign up as a bidder and take your chances on the auction floor!

Friday, July 19



FRIDAY EVENING BANQUET KEYNOTE SPEAKER

Friday 6:00-9:00pm

Dewey will give a lively rendition of Bee Tales -how we might or probably should not respond to those questions we all get as beekeepers from family, friends, the general public, new beekeepers and the boss. How we might respond when asked where should they locate their new colony or “will I get stung” or “how do I know what type of honey they are producing” or everyone’s favorite, “how much will it cost”? There are really no dumb questions just ill-informed answers!

FRIDAY AWARDS BANQUET

Cash Bar - Friday 5:00-9:00pm

Dinner - Friday 6:00-9:00pm

We'll start the evening with a cash bar and social open to everyone at 5:00 pm in the Piedmont Ballroom of the Hilton Hotel. At 6:30 pm, we'll gather for our annual Banquet and Awards Dinner where we recognize our new Master Beekeepers and recognize our host committees. Dinner is \$50 per person with a ticket purchased in advance. ***Please bring your ticket to dinner.***

We'll finish up the evening when EAS 2019 President, Buddy May, passes the gavel to Peggy McLaughlin, EAS 2020 President, to adjourn the evening until EAS 2020 in Maine. See this program and the EAS website for more information on upcoming EAS 2020.

CONFERENCE FEATURES

Painted Hives

Throughout conference

For the sixth year, the Nansemond Beekeepers Association is sponsoring a painted hive contest and sale. Starting in 2013, members of the Nansemond Beekeepers Association, headquartered in Smithfield, Virginia developed a painted hive contest to raise funds for honey bee research. The club members build and prime hives and then volunteer participants of all ages and skill levels, including elementary, middle and high school students, as well as adults and professionals pick up their hives and decorate them. The hives are displayed around the community accompanied by educational outreach. Citizens are encouraged to select a people's choice and bid via silent auction on a hive they would like to own. The competition culminates with a panel of invited judges awarding 1st, 2nd and 3rd place ribbons in each class.

The Nansemond Beekeepers Association has returned to EAS 2019 Conference to offer the hives in a silent auction that will end of Friday, July 19. Proceeds from the box sales will be donated to educational institutions and individuals for honey bee research so visit often and good luck on acquiring your favorite hives. They will look wonderful in your apiary but can also be used as small furniture such as an end table and be a lasting piece of art in your life.





America's Leading Source for Honey Packaging

USA made Glass & PET Classics · Invertible PET Bottles · Closure Options · 8 oz & 1 lb Muth Jars

Call us for more information or contact a Gamber Container Distributor in your area

ALL AMERICAN CONTAINER	813.248.2023	MCCOY'S SUNNY SOUTH APIARIES	561.798.1120
APIARIOS CARABALLO CORP.	787.537.7246	MCLURE'S HONEY & MAPLE PRODUCTS	603.444.6246
BETTERBEE, INC.	800.632.3379	MEADOW VIEW BEEKEEPING	610.737.7676
BLUE SKY BEE SUPPLY	877.529.9233	MERRITT CONTAINER CO.	850.962.9051
BAILEY BEE SUPPLY	919.241.4236	MILLER HONEY CO.	801.486.8479
DADANT & SONS	888.922.1293	ROSSMAN APIARIES	229.985.7200
DEER CREEK HONEY CO.	740.852.0899	SANDT HONEY COMPANY	610.252.6511
GLENN SHARPE	815.464.1566	SMITTY BEE HONEY INC.	888.469.4669
GUNTER HONEY CO.	540.955.1734	STILES APIARY	732.661.0700
HARVEY'S HONEY	856.358.1010	SWAN'S HONEY CO.	207.437.2251
HONEY HOUSE, INC.	417.451.4969	T.M. KLEIN & SONS	989.865.9377
JASON DODSON	931.698.4959	WALKER HONEY CO.	254.983.2337
MANN LAKE SUPPLY	800.880.7694	WALTER T. KELLEY	800.233.2899
		WIXSON HONEY CO.	607.243.7301



2220 DUTCH GOLD DRIVE · LANCASTER, PA 17601 · 717.393.1716 · FAX 717.393.8687

www.gambercontainer.com

Honey Show

Tuesday 3:00pm to 6:00pm and Wednesday 8:00am to 11:00am

Welcome to Greenville, SC. I want to encourage every attendee to consider entering our EAS Honey show this year. As always, we have many categories to choose from that will allow you to show off your talents in every aspect of beekeeping. Whether you suit up and get into your colonies, or prefer to show off your talents in photography or artistic endeavors, the honey show is for you.

It can be fun and rewarding competing against other beekeepers for awards and bragging rights, but the honey show is more than that. It is an educational opportunity, a way to help you improve your products and increase your profits. Our judges are highly trained and willing to share their knowledge to help you produce products of the highest quality.

The EAS Honey show is actually 7 shows, with multiple categories in each show. I am certain there is a category that will interest you. Each class has the potential of six ribbons to be awarded, so you have a great chance at winning a coveted EAS ribbon. We will also award SILVER awards for Best in Show, the Sweepstakes Award, and Silver plates for:

- Extracted Honey, Beeswax, Gadgets, Comb Honey, Mead & Honey Beer, Honey Cookery,
- Black Jar, Arts & Crafts, and Photography.

The following are the general rules that our judges will be using this year. Please read the rules carefully. Your entry is not being judged against the other entries, but against a perfect entry.

Good Luck!

Steve Genta
Honey Show Superintendent

Honey Exchange

Location: Rear Ballroom
Tuesday 8:00am-5:00pm
Wednesday 8:00am-3:00pm
Thursday 8:00am-5:00pm
Pickup: Friday 8:00am-2:00pm

Do you seek out honey from different areas of the country when you travel? So many of us do that EAS has established the Honey Exchange to facilitate our pursuit. Bring one, two, or three of your bee products and drop them off for an equal number of tickets to exchange for products from another beekeeper.



Get your Book Signed- Authors at EAS 2019

Wednesday through Friday 12:00pm to 12:30pm at entrance to vendor area.

A number of EAS speakers have books on bees and beekeeping. If you did not remember to bring books by these authors to EAS or do not have the latest copy, you can purchase books from one of the EAS vendors and bring it to the author to sign. Or you can, of course, always try to catch authors in the hall at other times and ask for their autograph. Expected author participants include Cindy Bee, Dewey Caron, Larry/Andrew Connor, Keith Delaplaine, Kim Flottum, Bill Hesbach, Mike Hood, Steve Repasky and Kirsten Traynor. Specific days for table signing will be posted at the Signing Booth.

Children's Program at EAS

Wednesday, August 15th 10:00am - 11:30am*

The Children's Program will be promoting beekeeping in all aspects to children. The children will be introduced to bees- beginning with identification of the queen, worker and drone. They will have an opportunity to handle equipment used in beekeeping. They will be introduced to flower morphology, honey production and the extraction process.



OTHER LOCAL ATTRACTIONS AND EVENTS

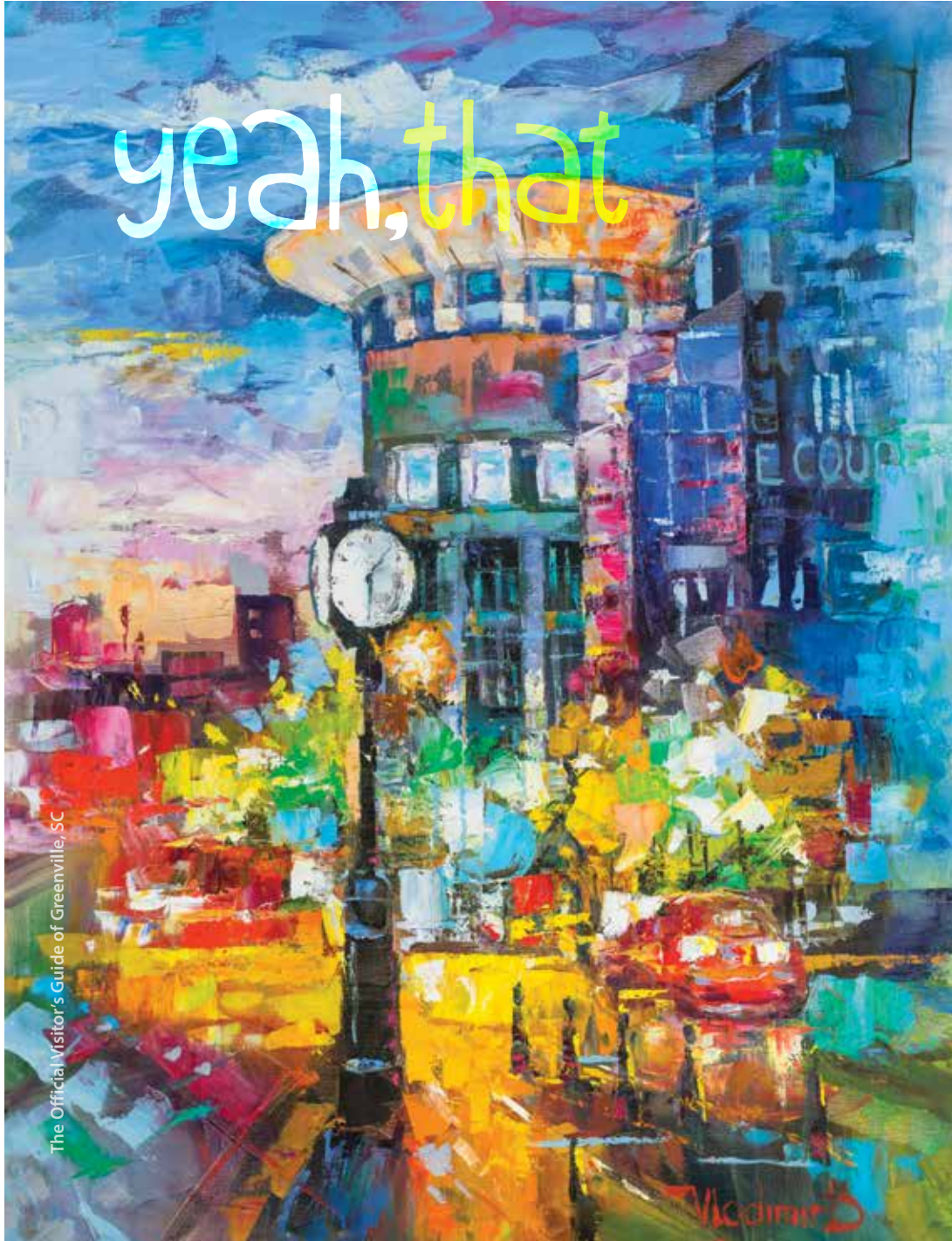

GREENVILLE, SOUTH CAROLINA VISITORS GUIDE

The Greenville South Carolina Guide has been generously provided by the Greenville Visitor Bureau in our Conference Bags. It is a source rich in information about Greenville and the surrounding areas!

COME SEE MAINE FOR EAS 2020!

By Peggy McLaughlin

Join us next summer in the great state of Maine for a week of fun and exceptional beekeeping education. Mark your calendars for August 3-7, 2020 and set your GPS to the University of Maine in Orono for the 65th EAS Short Course and Conference.

We'll have all the great things you've come to expect from an EAS conference: nationally and internationally recognized speakers; beginning, intermediate and advanced short course tracks; sessions on queen rearing and microscopy; a children's program and on-site apiary. For 2020 there will be more hands-on workshops including cooking with honey, working with beeswax, and photography. Our aim is to cover it all during a week of "The Art and Science of Beekeeping."

You'll need a place to stay and there are plenty on campus or in the surrounding Bangor area from dorms and campsites to inns and hotels. There will be opportunities for fun activities during the week including a trip to a commercial apiary and a stop at our state's largest woodenware manufacturer to peek inside their busy

workshop. In between sessions you can stretch your legs and breathe in the refreshing New England air on a network of campus hiking trails. University tours will include the Hudson Museum of ethnographic and archeological artifacts, the Wind & Wave research lab, and the Jordan Planetarium.

We also have plans in the works for a special Story Concert at a local brewery where attendees will be able to share their unique and often humorous experiences as beekeepers. And of course, no trip to Maine would be complete without a taste of our best loved foods. So, rest assured, there will be lobster, spuds and blueberries on the menu.

Come expand your apicultural knowledge, develop valuable beekeeping skills, and make new friends. Maine is The Place to Bee in 2020. We look forward to hosting you!



Photo Credit: Jennifer Lund





We Now Offer Wax Working!

Got Wax?
Need Foundation?
Give us a call!
(800) 233-2899



Kelley Beekeeping

www.kelleybees.com | 800-233-2899

Setting the Gold Standard for Natural Beekeeping!



Gold Star Honeybees®



What makes our hives so amazing?

It's all about what goes on inside the hive... natural beeswax, made by bees, for bees - for truly natural beekeeping.



Check out our books and **Thinking Beekeepers** Educational Series

Now made with beautiful, long-lasting, sustainable Cypress. **Go all-natural today with Gold Star Honeybees Top Bar Hives!**

Place your order online or call:
GoldStarHoneybees.com | 828-552-5225

Be sure to check out our New-Bee Top Bar Hive Kits online. Kits include everything you will need to get started with natural beekeeping.

Superior *Bee*

Polystyrene Bee Hives



Summer Special
Free Dose of DFM With Every Order!

6 Frame \$54.95
10 Frame \$64.95

Superior Bee
7199 Mt. Gilead Rd.
Fredericktown, OH 43019

Made in USA - full line of supplies

2" thick wall with R8 insulation value!

Toll Free 844-260-2015

Business 937-464-4422

The next generation of hive ware

E-mail: superiorbees@gmail.com

got brood?



broodminder knows

We watch while you're away...

BroodMinder is the industry leader in the wireless gathering, monitoring and disseminating of hive information to enhance honeybee health.

This simple idea began when a backyard beekeeper with an engineering background realized that there was no reliable data that gave an accurate picture of what was happening in hives... especially in colder months. With BroodMinder products, now you can know.

BroodMinder benefits:

- **Temperature, humidity and weight** information sent wirelessly
- **Better tools** to assess hive distress and provide insight
- **Improved outcomes** by helping develop solutions and new interventions
- **Data sharing** among the beekeeping community through the BeeCounted.org website
- **Over 8000 devices** in use since 2015

Stable temperature in the Brood Zone indicates bees are raising brood.

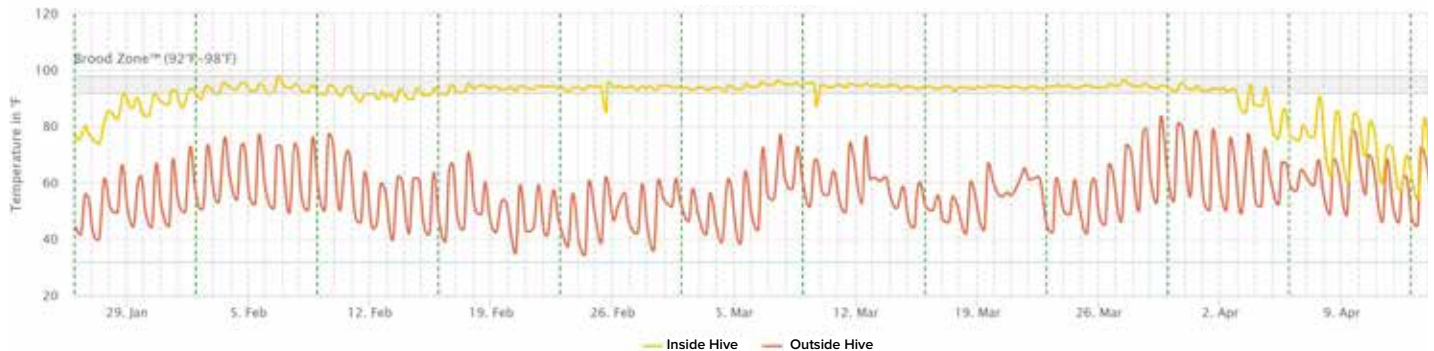

To learn more, go to BroodMinder.com or e-mail us at Info@BroodMinder.com